



***G2000 SERIES
GAS BAKE/ROAST
DECK OVENS***

PARTS LIST

Toll Free Phone, (US & Canada): (800) 427-6668

Toll Free Fax, (US & Canada): (800) 361-7745

<http://www.garland-group.com>



***G2000 SERIES
GAS BAKE/ROAST
DECK OVENS***

Contents:

Model Number Designations Page 5
G-2000 Series Gas Bake/Roast Deck Ovens..... Page 6
Revision History..... Page 11

Series G-2000 Model Number designations

The series G-2000 Bake and Roast oven model numbers are described as follows:

The prefix letter "G" indicated a gas unit. The second figure being (2) indicated 2000 Series. The third and fourth figure indicates the model oven as related to the oven chamber opening height, numbers after the - indicate combination ovens, see illustration.

When ordering replacement parts for the Gas 2000 Series deck ovens it is important to use the correct quantity column for that specific deck. Example: door height, door hinges, orifice size are different.

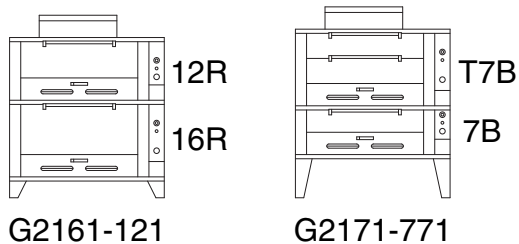
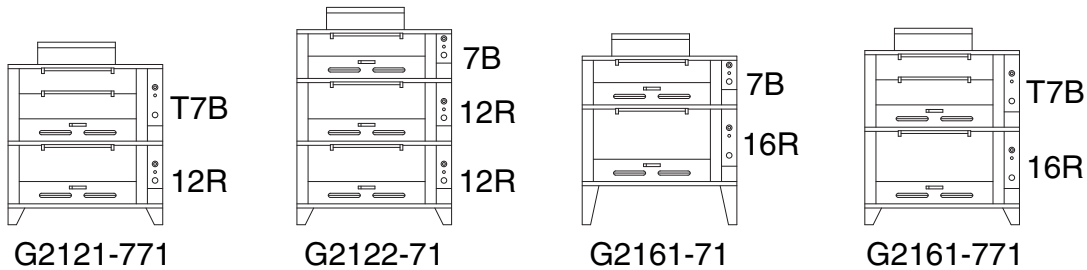
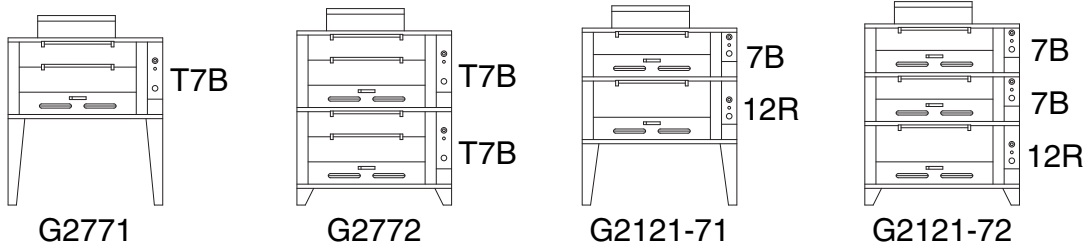
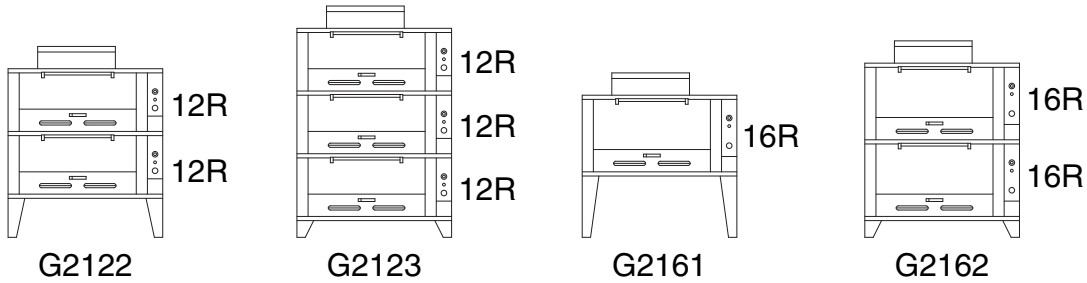
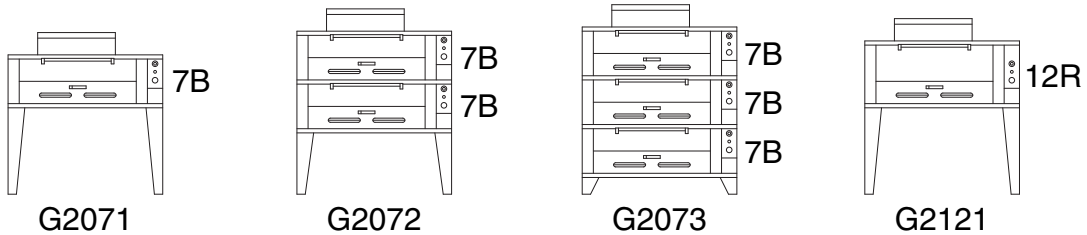

7B = 7" Bake
T7B = Twin 7" Bake
12R = 12" Roast
16R = 16" Roast

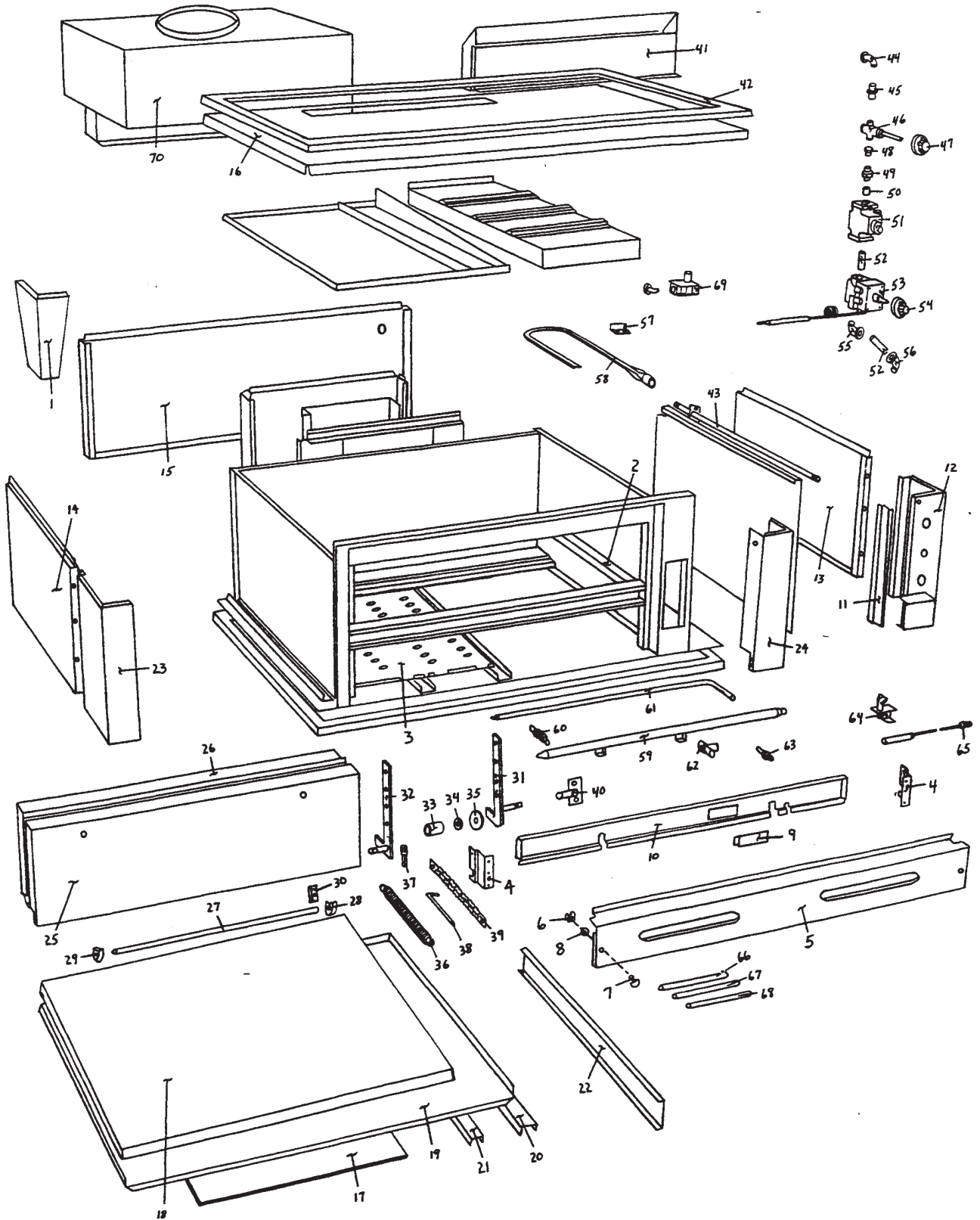

GARLAND PARTS IDENTIFICATION
G-2000 Series Gas Bake/Roast Deck Ovens

ITEM	PART #	DESCRIPTION	QUANTITY				DATE	
			MODEL				UP TO	FROM
			G2071	G2121	G2161	G2771		
Section A: Legs								
1	10526210	Leg Assy. 6" Granite Gray						
	10526213	Leg Assy. 6" S/S						
	10526211	Leg Assy. 14" Granite Gray						
	10526214	Leg Assy. 14" S/S						
	10526212	Leg Assy. 22" Granite Gray			4			
	10526215	Leg Assy. 22" S/S			4			
	10526201	Leg Assy. 31" Granite Gray	4	4		4		
	10526216	Leg Assy. 31" S/S	4	4		4		
Section B: Oven								
2	1170899	Heath Frame Assy	1	1	1	2		
4	1053700	Lower Front Panel Bracket	2	2	2	2		
5	1180800	Lower Front Panel (Granite Gray)	1	1	1	1		
	1180801	Lower Front Panel S/S	1	1	1	1		
6	1057700	1/4 Turn Receptacle	2	2	2	2		
7	8005001	1/4 Turn Fastener	2	2	2	2		
9	1053805	Air Shield Door	1	1	1	1		
10	1178400	Air Shield	1	1	1	1		
	1054000	Bulb Shield	1	1	1	1		
11	1178600	Valve Panel Mounting Bracket	1					
	1178601	Valve Panel Mounting Bracket		1				
	1178602	Valve Panel Mounting Bracket			1	1		
12	1178799	Valve Panel Assy (Granite Gray)	1					
	1178798	Valve Panel Assy S/S	1					
	1178797	Valve Panel Assy (Granite Gray)		1				
	1178796	Valve Panel Assy S/S		1				
	1178795	Valve Panel Assy (Granite Gray)			1	1		
	1178794	Valve Panel Assy S/S			1	1		
13	1179000	Body Side R/H (Granite Gary)	1					
	1179001	Body Side R/H S/S	1					
	1179004	Body Side R/H (Granite Gary)		1				
	1179005	Body Side R/H S/S		1				
	1179008	Body Side R/H (Granite Gary)			1	1		
	1179009	Body Side R/H S/S			1	1		
14	1179002	Body Side L/H (Granite Gary)	1					
	1179003	Body Side L/H S/S	1					
	1179006	Body Side L/H (Granite Gary)		1				
	1179007	Body Side L/H S/S		1				
	1179010	Body Side L/H (Granite Gary)			1	1		
	1179011	Body Side L/H S/S			1	1		
15	1179100	Main Back (Granite Gray)	1					
	1179101	Main Back S/S	1					
	1179102	Main Back (Granite Gray)		1				
	1179103	Main Back S/S		1				
	1179104	Main Back (Granite Gray)			1	1		
	1179105	Main Back S/S			1	1		

* NOT ILLUSTRATED

RECOMMENDED STOCK PARTS

GARLAND PARTS IDENTIFICATION
G-2000 Series Gas Bake/Roast Deck Ovens

ITEM	PART #	DESCRIPTION	QUANTITY				DATE	
			MODEL				UP TO	FROM
			G2071	G2121	G2161	G2771		
16	1179300	Main Top (Granite Gray)	1	1	1	1		
	1179301	Main Top S/S	1	1	1	1		
*	1179699	Heat Deflector Assy.	1	1	1	2		
17	1179700	Heat Deflector	1	1	1	2		
18	1559700	Cordierite Deck	2			4		
	1030700	Heath Core Plate - OBS NLA	1			2	22-Nov-88	
19	1179899	Steel Hearth Assy		1	1			
20	1559200	Heat Deflector Pans	2	2	2	4		
	1509500	Heat Diverter	1	1	1	2		
	1179900	Rear Hearth Filler OBS NLA	1			2	22-Nov-88	
21	1179901	Side Hearth Filler Used W/Steel Deck Only	2	2	2	4		
22*	1179902	Inner Oven Lining	2	2	2	4		
23	1181600	Corner Column (Granite Gray)	1					
	1181601	Corner Column S/S	1					
	1181602	Corner Column (Granite Gray)		1				
	1181603	Corner Column S/S		1				
	1181604	Corner Column (Granite Gray)			1	1		
24	1181605	Corner Column S/S			1	1		
	1181504	Center Column (Granite Gray)	1					
	1181505	Center Column S/S	1					
	1181502	Center Column (Granite Gray)		1				
	1181503	Center Column S/S		1				
	1181500	Center Column (Granite Gray)			1	1		
*	1181501	Center Column S/S			1	1		
	1182099	Door Assy. Complete W/O Window (Granite Gray)	1			2		
	1182098	Door Assy. Complete W/O Window S/S	1			2		
	1182093	Door Assy. Complete (Granite Gray)		1				
	1182092	Door Assy. Complete S/S		1				
	1182090	Door Assy. Complete (Granite Gray)			1			
	1182089	Door Assy. Complete S/S			1			
25	1182000	Door Panel (Granite Gray)	1			2		
	1182001	Door Panel S/S	1			2		
	1182011	Door Panel (Granite Gray)		1				
	1182012	Door Panel S/S		1				
	1182014	Door Panel (Granite Gray)			1			
	1182015	Door Panel S/S			1			
26	1182097	Door Liner Assy.	1			2		
	1182091	Door Liner Assy.		1				
	1182088	Door Liner Assy.			1			
*	1016799	Oven Door Handle Assy.	1	1	1	2		
27	1016714	Door Handle	1	1	1	2		
28	1016701	Handle End R/H	1	1	1	2		
29	1016702	Handle End L/H	1	1	1	2		
30	1016703	Insulator Door Handle	2	2	2	4		
*	1179798	Spring Bracket Assy. R/H	1	1	1			
	1179799	Spring Bracket Assy. L/H			1			
	1179797	Spring Bracket Assy. R/H				1		

* NOT ILLUSTRATED

RECOMMENDED STOCK PARTS

GARLAND PARTS IDENTIFICATION
G-2000 Series Gas Bake/Roast Deck Ovens

ITEM	PART #	DESCRIPTION	QUANTITY				DATE	
			MODEL				UP TO	FROM
			G2071	G2121	G2161	G2771		
31	1180399	Door Hinge Assy. R/H	1			2		
	1180397	Door Hinge Assy. R/H		1				
	1180395	Door Hinge Assy. R/H			1			
32	1180398	Door Hinge Assy. L/H	1			2		
	1180396	Door Hinge Assy. L/H		1				
	1180394	Door Hinge Assy. L/H			1			
33	1054330	Graphited Bearing	4	4	4	8		
34	1011201	Steel Tubing Spacer	2	2	2	4		
35	1082700	Harness Ring	2	2	2	4		
36	1005800	Door Spring	1	1	2	2		
37	1054325	Door Shaft Finger	1	1	2	2		
38	9004701	Spring Hook	1	1		2		
	1057400	Eye Bolt			2			
39	1021100	Roller Chain	1	1	2	2		
*	1021299	Connecting Link Assy.	1	1	2	2		
40	1056799	Trunion Support	2	2	2	4		
41	1056397	Flue Diverter Assy. (Granite Gray)	1	1	1	1		
42	1181299	Top Trim Cap Assy. (Granite Gray)	1	1	1	1		
	1181298	Top Trim Cap Assy. S/S	1	1	1	1		
Section C: Controls								
43	1179598	Tail Pipe Weld Assy.	1	1	1	1		
44	1026714	Reducing Elbow 3/4 to 3/8	1	1	1	1		
45	1027999	Straight Connector 1/8 NPT to 1/4 CC	1	1	1	1		
46	1017200	On-Off Gas Valve	1	1	1	1		
47	1314002	Dial	1	1	1	1		
	1314121	Dial Insert	1	1	1	1		
48	1038401	Reducing Bushing	1	1	1	1		
49	1026903	Union 1/2 NPT	1	1	1	1		
50	1004640	Closed Nipple 1/2 NPT	1	1	1	1		
51	1027001	TS11J Safety Valve 1/2 NPT	1	1	1	1		
52	1004641	Nipple 1/2 x 1 1/2 NPT	2	2	2	2		
53	1017514	FDO Thermostat	1	1	1	1		
54	1017515	Thermostat 150° - 500°	1	1	1	1		
55	1026733	Street Elbow 1/2 NPT	1	1	1	1		
56	1026921	90° Elbow Union 1/2 NPT	1	1	1	1		
Section D: Burners								
57	1052600	Burner Support	2	2	2	2		
58	1050498	Burner Assy.	2	2	2	2		
*	1050401	Air Shutter	2	2	2	2		
59	1050096	Manifold Weld Assy.	1	1	1	1		
60	1017698	Orifice Fitting Assy. Nat.	2	2				
	1017697	Orifice Fitting Assy. Pro	2	2				
	1017696	Orifice Fitting Assy. Nat.			2	2		
	1017695	Orifice Fitting Assy. Pro			2	2		

* NOT ILLUSTRATED

RECOMMENDED STOCK PARTS

GARLAND PARTS IDENTIFICATION
G-2000 Series Gas Bake/Roast Deck Ovens

ITEM	PART #	DESCRIPTION	QUANTITY				DATE	
			MODEL				UP TO	FROM
			G2071	G2121	G2161	G2771		
*	1021349	Orifice Hood Nat.	2	2				
	1021355	Orifice Hood Pro.	2	2				
	1021346	Orifice Hood Nat.			2	2		
	1021354	Orifice Hood Pro.			2	2		
*	1007300	Pipe Plug 1/8 NPT	1	1	1	1		
*	1052800	Lighter Tube Support Center	3	3	3	3		
61	1050500	Lighter Tube	1	1	1	1		
62	1050100	Lighter Tube Tee	1	1	1	1		
63	1050360	Orifice Fitting Nat.	1	1	1	1		
	1050271	Orifice Fitting Pro.	1	1	1	1		
*	1587200	Pilot Bracket	1	1	1	1		
*	1028297	Pilot Assy. Nat.	1	1	1	1		
	1028296	Pilot Assy. Pro.	1	1	1	1		
64	1028200	Pilot 2-CH-10	1	1	1	1		
*	1028202	Orifice Bell #18 Nat.	1	1	1	1		
	1028203	Orifice Bell #10 Pro.	1	1	1	1		
*	1019503	Reducing Ferrule	1	1	1	1		
*	1019504	Compression Nut	1	1	1	1		
65	1019436	Thermocouple 36"	1	1	1	1		
66	1028720	Pilot Adjusting Tubing 1/4 x 20" (Gum Valve To Safety)	1	1	1	1		
69	1019003	Pressure Regulator Nat.	1	1	1	1		
	1019011	Pressure Regulator Pro.	1	1	1	1		
*	1009071	Installers and Owners Manual	1	1	1	1		
Optional								
70	1056497	Draft Hood Assy. Granite Gray	1	1	1	1		
	1056496	Draft Hood Assy. S/S	1	1	1	1		
*	1180499	Shelf Angle R/H		1	1			
	1180498	Shelf Angle L/H		1	1			
*	1180404	Shelf Support R/H		1				
	1180402	Shelf Support R/H			1			
*	1180405	Shelf Support L/H		1				
	1180403	Shelf Support L/H			1			
*	1180420	Oven Rack		1	1			
*	1182096	Door Assy. Complete W/ Window Granite Gray	1			2		
	1182095	Door Assy. Complete S/S	1			2		
*	1182005	Door Panel Granite Gray	1			2		
	1182006	Door Panel S/S	1			2		
*	1182094	Door Liner Assy. W/Window	1			2		
*	1182010	Window (Was) P-1464 Mills Products	1			2		
*	1182010	Light Switch Momentary	1			2		
*	1029501	Light Cord	1			2		

* NOT ILLUSTRATED

RECOMMENDED STOCK PARTS

GARLAND PARTS IDENTIFICATION

Revision History

REV. #	PAGE #	ITEM #	NOTE	DATE
1			Entire Book Reformatted	Jan 06/05

 **GARLAND**[®]