

# Induction RTCSmp Dual Hobs

## Countertop and Built-In Line Models

---

### Parts List

**Built-In Line Dual Hobs Model  
SH/DU/IN**



**Countertop Line Dual Hobs Model  
SH/DU/BA**



## Rating Plate Location



## Serial Number (S/N) Explained

The serial number of your unit is listed on the rating plate.

Example: IN 01 . 00014 . 1213

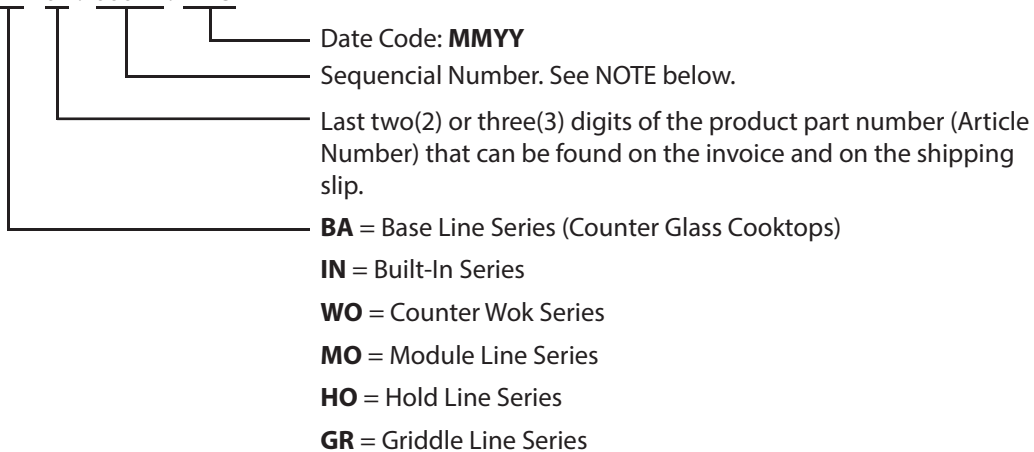

### NOTE: non-RTCS / RTCS / RTCSmp models

- A non-RTCS/RTCSmp unit has a 4-Digit Sequence Number.
- A RTCS or RTCSmp unit has a 5-Digit Sequence Number.
- A RTCSmp unit is indicated as such on the Rating Plate.

## Nomenclature and Models

Series	Style	Function	Built-in	Power (Watt)	Models
SH = Slim Hob	DU = Dual Hobs	BA = Base Line		7000 (2x 3500) 10000 (2x 5000)	SH/DU/BA 7000 (2x 3500) SH/DU/BA 10000 (2x 5000)
			IN = Built-In Line	7000 (2x 3500) 10000 (2x 5000)	SH/DU/IN 7000 (2x 3500) SH/DU/IN 10000 (2x 5000)

## Table of Contents

---

Rating Plate Location, Serial Number and Nomenclature Information .....	<b>2</b>
Built-In Dual Hobs — SH DU IN 7000 (2x 3500), 7kW, 208/400/440V, 50/60Hz, 3Phase .....	<b>4</b>
Built-In Dual Hobs — SH DU IN 10000 (2x5000), 10kW, 208/400/440V, 50/60Hz, 3Phase .....	<b>6</b>
Countertop Dual Hobs — SH DU BA 7000(2x 3500), 7kW, 208/400/440V, 50/60Hz, 3Phase .....	<b>8</b>
Countertop Dual Hobs — SH DU BA 10000(2x5000), 10kW, 208/400/440V, 50/60Hz, 3Phase .....	<b>10</b>
Countertop Dual Hobs — (Built Before 2013) SH DU BA 10000(2x5000), 10kW, 208V, 50/60Hz, 3Phase	<b>12</b>
Countertop Dual Hobs — SH DU BA 7000(2x3500), 7kW, 220V, 50/60Hz, 3Phase .....	<b>14</b>
Repair Accessories .....	<b>16</b>
Revision History .....	<b>17</b>

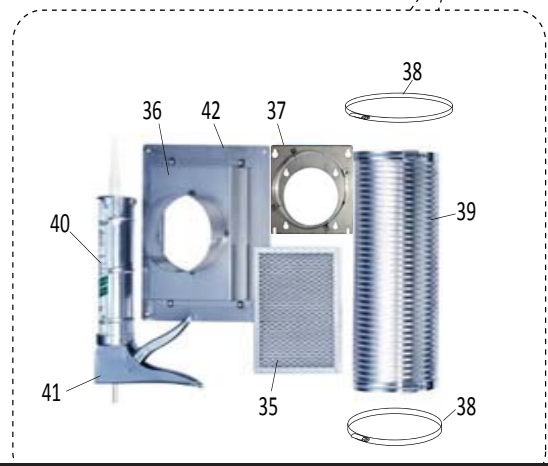
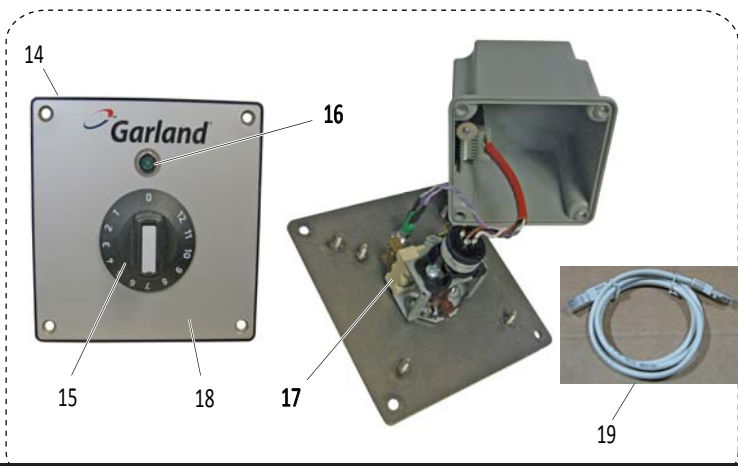
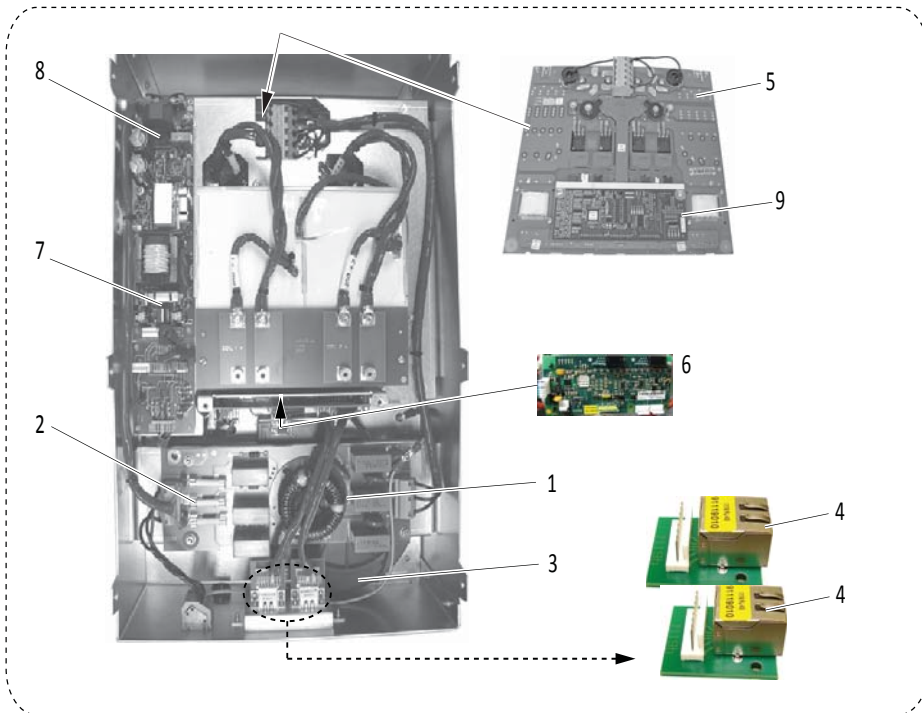
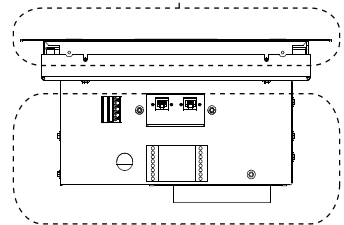
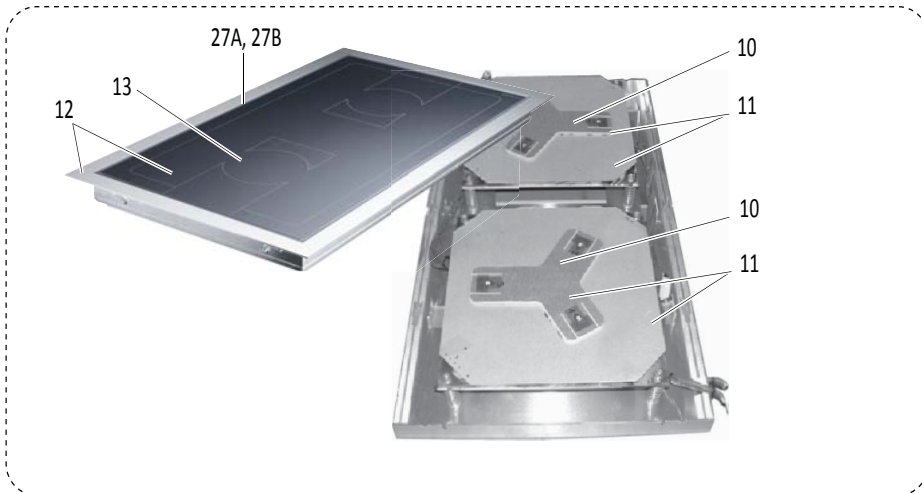

**GARLAND PARTS IDENTIFICATION**  
**RTCSmp Induction Built-In Line, Dual Hobs, 7kW (2x 3.5kW)**

*models*

**SH DU IN 7000 (2x 3500)/ Article No. 99580101/ 7.0kW(2x 3.5kW) 208V 22A 60Hz 3Phase**

**SH DU IN 7000 (2x 3500)/ Article No. 99580103/ 7.0kW(2x 3.5kW) 400V 11A 50Hz 3Phase**

**SH DU IN 7000 (2x 3500)/ Article No. 99580104/ 7.0kW(2x 3.5kW) 440V 10A 50Hz 3Phase**

ITEM	PART #	DESCRIPTION	QUANTITY			CRITICAL
			208V	400V	440V	
1	91168030	Mains Line Filter Board/Print	1			
	91167010	Mains Line Filter Board/Print		1	1	
2	34150259	<b>Fuse T25A 250V 6.3 x 32</b>	6	3	3	C
3	94090007	<b>Fan 24VDC 22W</b>	1	1	1	C
4	91119010	<b>RJ-45 Print/Board 119</b>	2	2	2	C
5	98012661	<b>Power Board, 208V</b>	1			C
	98012611	<b>Power Board, 400V</b>		1		C
	98012681	<b>Power Board, 440V</b>			1	C
6	91133120	<b>(Board/Print I133) RTCSmp Dual Hobs with IR Board</b>	1	1	1	
7	91120032	<b>Board (Print) I120, AC/DC, 208V</b>	1			
	91120022	<b>Board (Print) I120, AC/DC, 400-440V</b>		1	1	
8	91109012	<b>Board (Print) I109c, Supply &amp; CAN-BUS Interface</b>	1	1	1	
9	91131100	CPU Board (Print), 208V	1			
	91131010	CPU Board (Print), 400V		1		
	91131130	CPU Board (Print), 440V			1	
10	94040130	<b>Sensor Unit, Round Coil, 3 x PT 1k</b>	2	2	2	C
11	93005030	Induction Coil #5.03, with 3 x PT Sensors	2			
	93017053	Induction Coil #17.05, with 3 x PT Sensors		2	2	
12	98300022	Built-in Frame Complete Assembly SH/DU/IN (with Glass)	1	1	1	
13	77325801	Ceran Glass 320x 580x 4mm	1	1	1	
14	94030028	<b>Operation Unit RJ-45, without Cable (incl. items#15,16,17)</b>	2	2	2	C
15	39400001	<b>Plastic Knob, 0-12</b>	2	2	2	
16	35624009	<b>Indicator Lamp, 24V, LED, Green</b>	2	2	2	
17	94010001	<b>Power Switch 2 Pol with Potentiometer</b>	2	2	2	C
18	66000067	Overlay, Garland, Square (Option)	1	1	1	
19	38602063	Cable, RJ45, 1-meter	1	1	1	
27A	70000003	Silicone Strip 565x 6x 4mm (for Glass Installation)	2	2	2	
27B	70000002	Silicone Strip 305x 6x 4mm (for Glass Installation)	2	2	2	
34	95000020	Kit, Fresh Air Intake Kit for Built-In, Dual Model	1	1	1	
35	71000003	<b>Air Intake Filter 200x 150x 12mm</b>	1	1	1	
36	72183091	Grease Filter Holder/Frame	1	1	1	
37	72263011	Air Conductor Holder, Dual	1	1	1	
38	76000002	Clamp	2	2	2	
39	76000001	Air Conductor Aluminum	1	1	1	
40	70000015	Silicone Glue PACTAN 7076 (for Glass Installation)	1	1	1	
41	76000003	Caulking Gun (for Glass Installation)	1	1	1	
42	72204090	Grease Filter Holder/Frame, Front Plate	1	1	1	

\* NOT ILLUSTRATED

**RECOMMENDED STOCK PARTS**

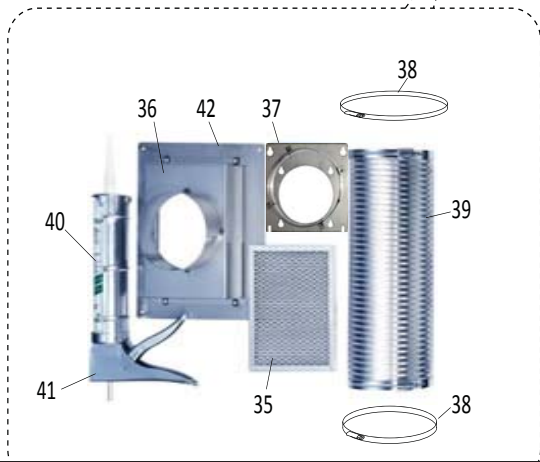
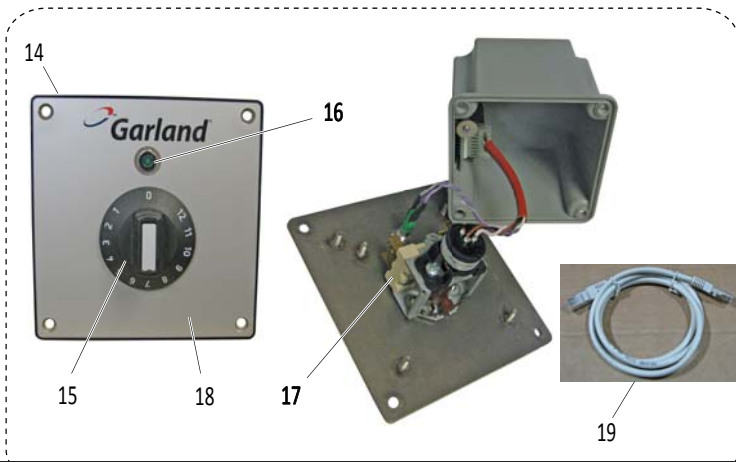
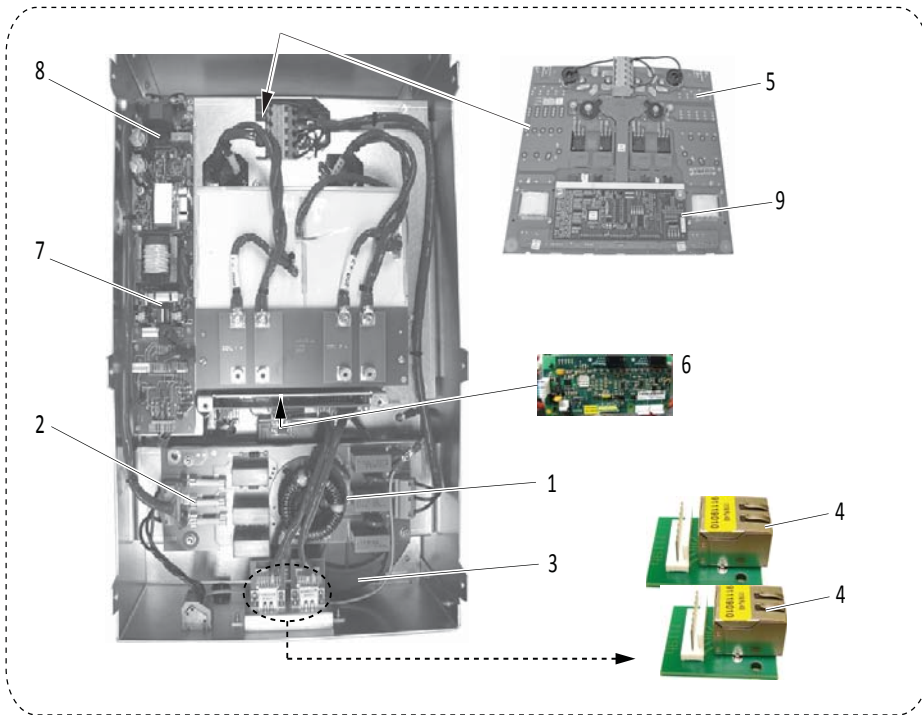
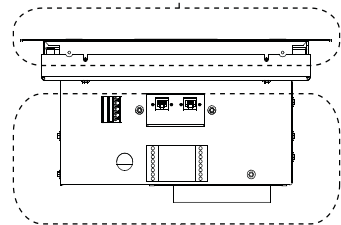
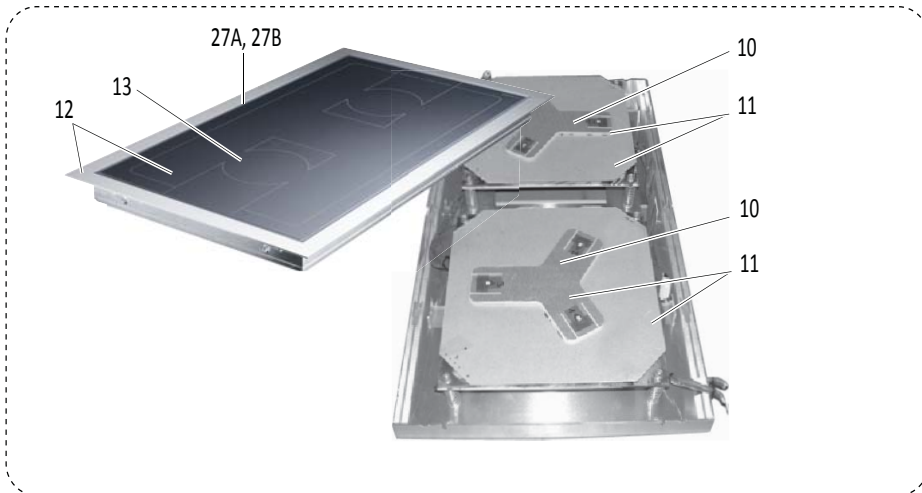

**GARLAND PARTS IDENTIFICATION**  
**RTCSmp Induction Built-In Line, Dual Hobs, 10kW (2x 5.0kW)**

*models*

**SH DU IN 10000(2x5000)/ Article No. 99580105/ 10kW(2x 5.0kW) 208V 30A 60Hz 3Phase**

**SH DU IN 10000(2x5000)/ Article No. 99580107/ 10kW(2x 5.0kW) 400V 16A 50Hz 3Phase**

**SH DU IN 10000(2x5000)/ Article No. 99580108/ 10kW(2x 5.0kW) 440V 15A 50Hz 3Phase**

ITEM	PART #	DESCRIPTION	QUANTITY			CRITICAL
			208V	400V	440V	
1	91168030	Mains Line Filter Board/Print	1			
	91167010	Mains Line Filter Board/Print		1	1	
2	34150259	<b>Fuse T25A 250V 6.3 x 32</b>	6	3	3	C
3	94090007	<b>Axial Fan 24VDC 22W</b>	1	1	1	C
4	91119010	<b>RJ-45 Print/Board 119</b>	2	2	2	C
5	98012661	<b>Power Board, 208V</b>	1			C
	98012611	<b>Power Board, 400V</b>		1		C
	98012681	<b>Power Board, 440V</b>			1	C
6	91133120	<b>(Board/Print I133) RTCSmp Dual Hobs with IR Board</b>	1	1	1	
7	91120032	<b>Board (Print) I120, AC/DC, 208V</b>	1			
	91120022	<b>Board (Print) I120, AC/DC, 400-440V</b>		1	1	
8	91109012	<b>Board (Print) I109c, Supply &amp; CAN-BUS Interface</b>	1	1	1	
9	91131140	CPU Board (Print), 208V	1			
	91131010	CPU Board (Print), 400V		1		
	91131170	CPU Board (Print), 440V			1	
10	94040130	<b>Sensor Unit, Round Coil, 3 x PT 1k</b>	2	2	2	C
11	93005030	Induction Coil #5.03, with 3 x PT Sensors	2			
	93017053	Induction Coil #17.05, with 3 x PT Sensors		2	2	
12	98300022	Built-in Frame Complete Assembly SH/DU/IN, with Glass	1	1	1	
13	77325801	Ceran Glass 320x 580x 4mm	1	1	1	
14	94030028	<b>Operation Unit RJ-45, without Cable (incl. items#15,16,17)</b>	2	2	2	C
15	39400001	<b>Plastic Knob, 0-12</b>	2	2	2	
16	35624009	<b>Indicator Lamp, 24V, LED, Green</b>	2	2	2	
17	94010001	<b>Power Switch 2 Pol with Potentiometer</b>	2	2	2	C
18	66000067	Overlay, Garland, Square (Option)	1	1	1	
19	38602063	Cable, RJ45, 1-meter	1	1	1	
27A	70000003	Silicone Strip 565x 6x 4mm (for Glass Installation)	2	2	2	
27B	70000002	Silicone Strip 305x 6x 4mm (for Glass Installation)	2	2	2	
34	95000020	Kit, Fresh Air Intake Kit for Built-In, Dual Model	1	1	1	
35	71000003	<b>Air Intake Filter 200x 150x 12mm</b>	1	1	1	
36	72183091	Grease Filter Holder/Frame	1	1	1	
37	72263011	Air Conductor Holder, Dual	1	1	1	
38	76000002	Hose Clamp	2	2	2	
39	76000001	Air Conductor Aluminum	1	1	1	
40	70000015	Silicone Glue PACTAN 7076 (for Glass Installation)	1	1	1	
41	76000003	Caulking Gun (for Glass Installation)	1	1	1	
42	72204090	Grease Filter Holder/Frame, Front Plate	1	1	1	

\* NOT ILLUSTRATED

**RECOMMENDED STOCK PARTS**

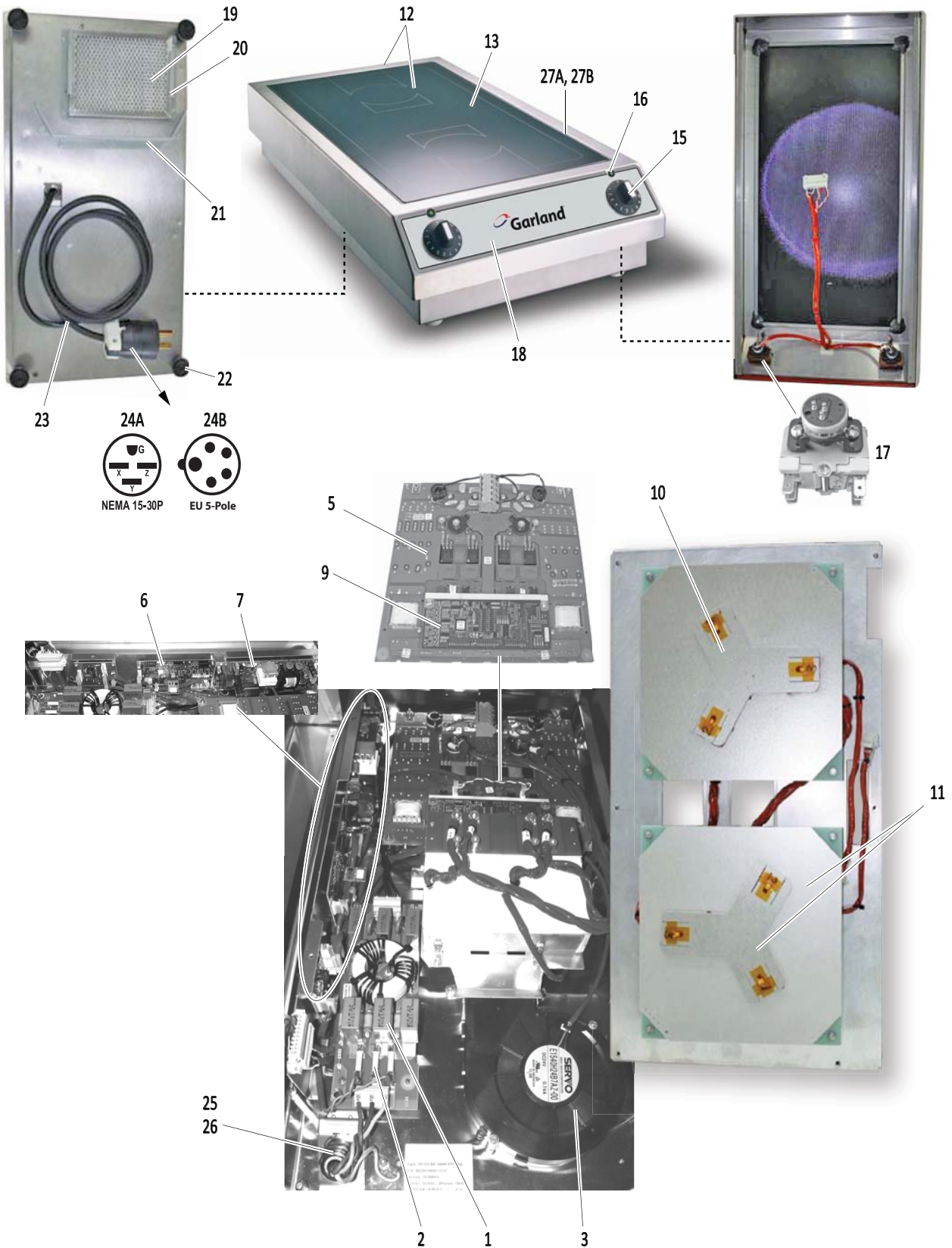

**GARLAND PARTS IDENTIFICATION**  
**RTCSmp Induction Countertop Line, Dual Hobs, 7kW (2x 3.5kW)**

*models*

**SH DU BA 7000 (2x3500)/ Article No. 99560201/ 7.0kW(2x 3.5kW) 208V 22A 60Hz 3Phase**

**SH DU BA 7000 (2x3500)/ Article No. 99560203/ 7.0kW(2x 3.5kW) 400V 11A 50Hz 3Phase**

**SH DU BA 7000 (2x3500)/ Article No. 99560204/ 7.0kW(2x 3.5kW) 440V 10A 50Hz 3Phase**

ITEM	PART #	DESCRIPTION	QUANTITY			CRITICAL
			208V	400V	440V	
1	91168030	Mains Line Filter Board/Print	1			
	91167010	Mains Line Filter Board/Print		1	1	
2	34150259	<b>Fuse T25A 250V 6.3 x 32</b>	6	3	3	C
3	94090009	<b>Radial Fan 24VDC 22W</b>	1	1	1	C
5	98012661	<b>Power Board, 208V</b>	1			C
	98012611	<b>Power Board, 400V</b>		1		C
	98012681	<b>Power Board, 440V</b>			1	C
6	91133120	<b>Board/Print I133 RTCSmp Dual Hobs with IR</b>	1	1	1	
7	91120032	<b>Board/Print I120, AC/DC, 208V</b>	1			
	91120022	<b>Board/Print I120, AC/DC, 400-440V</b>		1	1	
9	91131100	CPU Board/Print I131, 208V	1			
	91131010	CPU Board/Print I131, 400V		1		
	91131130	CPU Board/Print I131, 440V			1	
10	94040130	<b>Sensor Unit, Round Coil, 3 x PT 1k</b>	2	2	2	C
11	93005030	Induction Coil #5.03, with 3 x PT Sensors	2			
	93017053	Induction Coil #17.05, with 3 x PT Sensors		2	2	
12	98300102	Housing/Case, Upper, with Glass, SH/DU/BA	1	1	1	
13	77325801	Ceran Glass 320x 580x 4mm	1	1	1	
15	39400001	<b>Plastic Knob, 0-12</b>	2	2	2	
16	35624009	<b>Indicator Lamp, 24V, LED, Green</b>	2	2	2	
17	94010001	<b>Power Switch 2 Pol with Potentiometer</b>	2	2	2	C
18	66000003	Overlay, Garland, Dual	1	1	1	
19	71000003	<b>Air Intake Filter 200x 150x 12mm</b>	1	1	1	
20	72261030	Frame/Holder for Air Intake Filter	1	1	1	
21	72300520	Air Deflector SH/DU/BA	1	1	1	
22	95000120	<b>Foot, Complete Assembly</b>	4	4	4	
23	38324001	Mains Cable UL 4x AWG 10	1			
	38625050	Mains Cable VDE 4x 2.5mm2		1	1	
24A	32750401	Mains Plug USA NEMA 15-30P	1			
24B	32750503	Mains Plug EU 5-Pole 400V 16A		1		
25	39500012	Cable Connector Nut (Cable Gland PG 29)	1			
	39500011	Cable Connector Nut (Cable Gland PG 21)		1	1	
26	39500005	Screw Nut PG 29	1			
	39500004	Screw Nut PG 21		1	1	
27A	70000003	Silicone Strip 565x 6x 4mm (for Glass Installation)	2	2	2	
27B	70000002	Silicone Strip 305x 6x 4mm (for Glass Installation)	2	2	2	

\* NOT ILLUSTRATED

**RECOMMENDED STOCK PARTS**

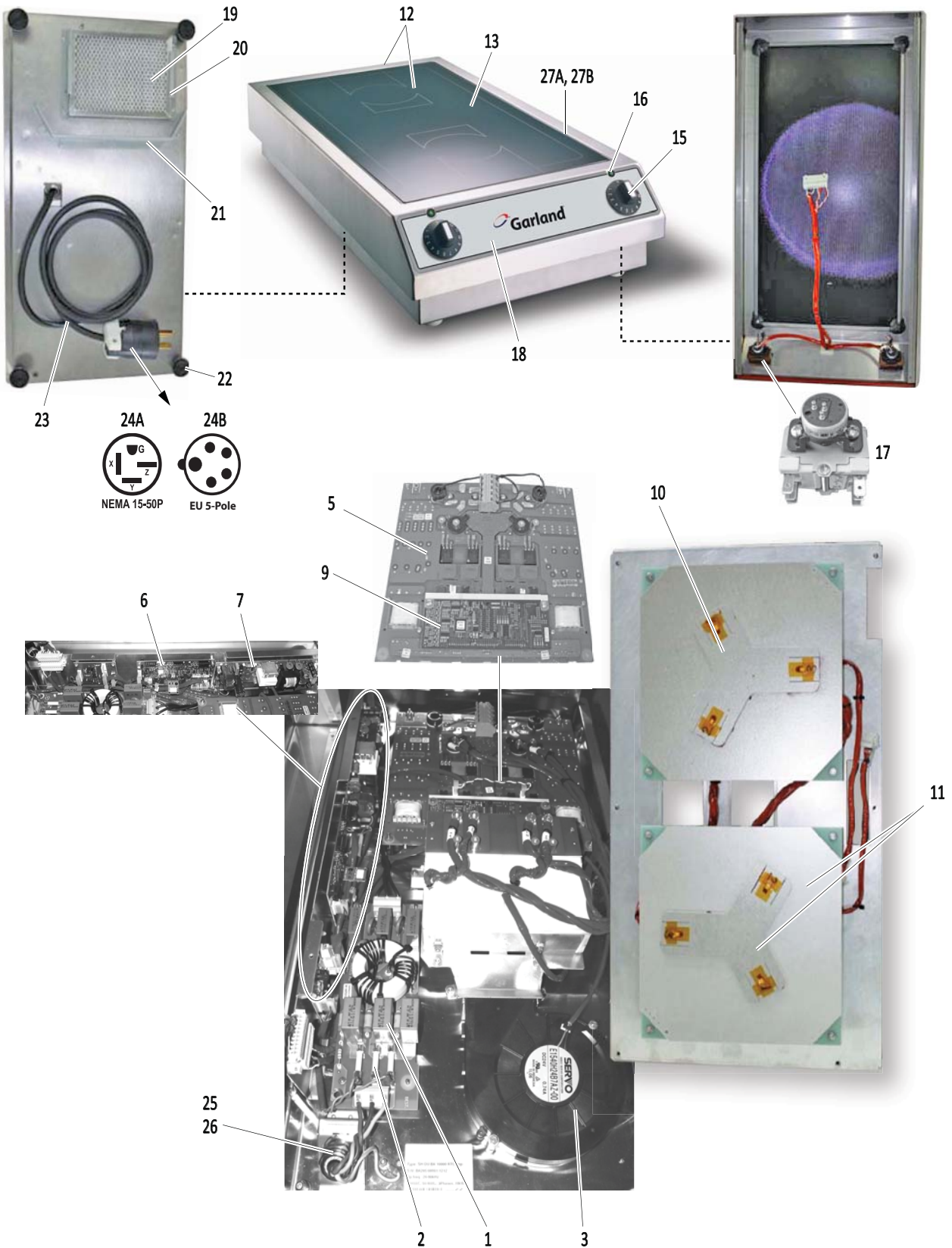

## GARLAND PARTS IDENTIFICATION

### RTCSmp Induction Countertop Line, Dual Hobs, 10kW (2x 5.0kW)

*models*

SH DU BA 10000 (2x5000)/ ArticleNo. 99560205/ 10kW(2x5.0kW) 208V 30A 60Hz 3Phase

SH DU BA 10000 (2x5000)/ ArticleNo. 99560207/ 10kW(2x5.0kW) 400V 16A 50Hz 3Phase

SH DU BA 10000 (2x5000)/ ArticleNo. 99560208/ 10kW(2x5.0kW) 440V 15A 50Hz 3Phase

ITEM	PART #	DESCRIPTION	QUANTITY			CRITICAL
			208V	400V	440V	
1	91168030	Mains Line Filter Board/Print	1			
	91167010	Mains Line Filter Board/Print		1	1	
2	<b>34150259</b>	<b>Fuse T25A 250V 6.3 x 32</b>	6	3	3	C
3	<b>94090009</b>	<b>Radial Fan 24VDC 22W</b>	1	1	1	C
5	<b>98012661</b>	<b>Power Board, 208V</b>	1			C
	<b>98012611</b>	<b>Power Board, 400V</b>		1		C
	<b>98012681</b>	<b>Power Board, 440V</b>			1	C
6	<b>91133120</b>	<b>Board/Print I133 RTCSmp Dual Hobs with IR</b>	1	1	1	
7	<b>91120032</b>	<b>Board/Print I120, AC/DC, 208V</b>	1			
	<b>91120022</b>	<b>Board/Print I120, AC/DC, 400-440V</b>		1	1	
9	91131140	CPU Board/Print I131, 208V, w/ firmware and parameters	1			
	91131010	CPU Board/Print I131, 400V, w/ firmware and parameters		1		
	91131170	CPU Board/Print I131, 440V, w/ firmware and parameters			1	
10	<b>94040130</b>	<b>Sensor Unit, Round Coil, 3 x PT 1k</b>	2	2	2	C
11	93005030	Induction Coil #5.03, with 3 x PT Sensors	2			
	93017053	Induction Coil #17.05, with 3 x PT Sensors		2	2	
12	98300102	Housing/Case, Upper, with Glass, SH/DU/BA	1	1	1	
13	77325801	Ceran Glass 320x 580x 4mm	1	1	1	
15	<b>39400001</b>	<b>Plastic Knob, 0-12</b>	2	2	2	
16	<b>35624009</b>	<b>Indicator Lamp, 24V, LED, Green</b>	2	2	2	
17	<b>94010001</b>	<b>Power Switch 2 Pol with Potentiometer</b>	2	2	2	C
18	66000003	Overlay, Garland, Dual Countertop	1	1	1	
19	<b>71000003</b>	<b>Air Intake Filter 200x 150x 12mm</b>	1	1	1	
20	72261030	Frame/Holder for Air Intake Filter	1	1	1	
21	72300520	Air Deflector SH/DU/BA	1	1	1	
22	<b>95000120</b>	<b>Foot, Complete Assembly</b>	4	4	4	
23	38340001	Mains Cable UL 4x AWG 8	1			
	38625050	Mains Cable VDE 4x 2.5mm2		1	1	
24A	32750402	Mains Plug USA NEMA 15-50P	1			
24B	32750503	Mains Plug EU 5-Pole 400V 16A		1		
25	39500012	Cable Connector Nut (Cable Gland PG 29)	1			
	39500011	Cable Connector Nut (Cable Gland PG 21)		1	1	
26	39500005	Screw Nut PG 29	1			
	39500004	Screw Nut PG 21		1	1	
27A	70000003	Silicone Strip 565x 6x 4mm (for Glass Installation)	2	2	2	
27B	70000002	Silicone Strip 305x 6x 4mm (for Glass Installation)	2	2	2	

\* NOT ILLUSTRATED

**RECOMMENDED STOCK PARTS**

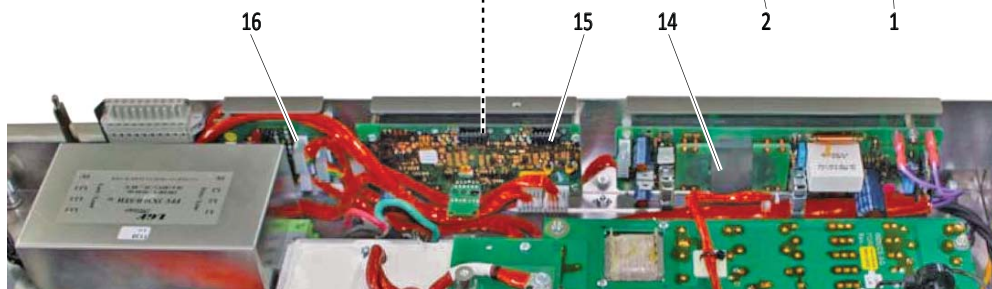
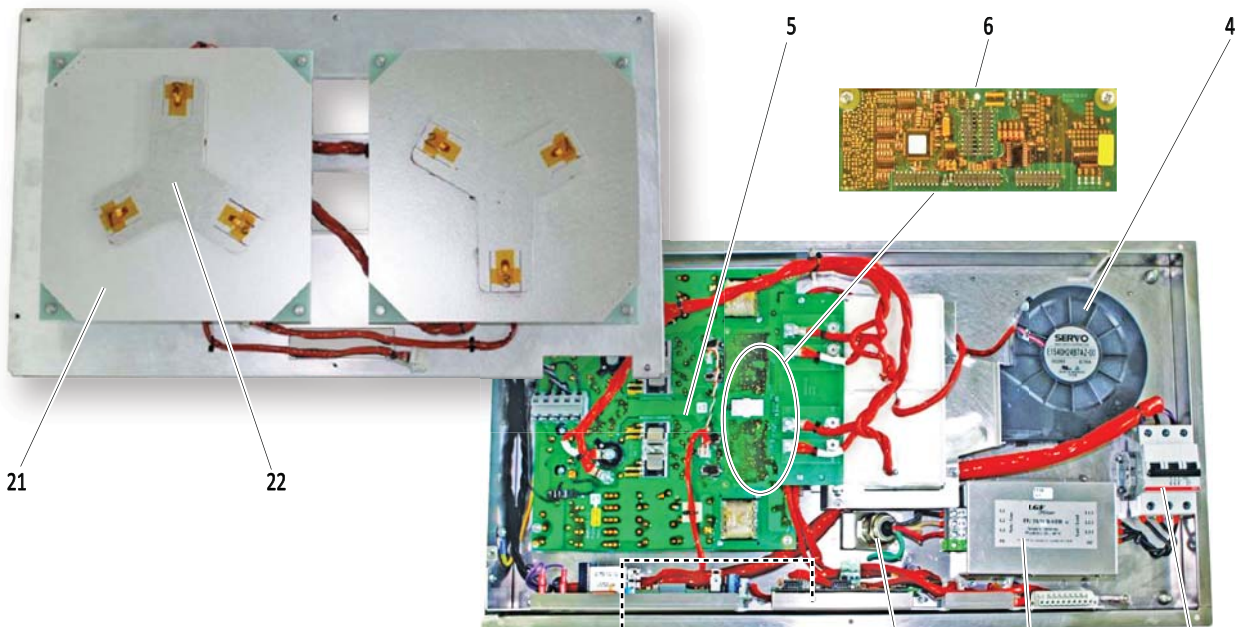

**GARLAND PARTS IDENTIFICATION**  
**RTCSmp Induction Countertop Line, Dual Hobs, 10kW (2x 5.0kW)**  
*model*  
**SH DU BA 10000 (2x5000)/ ArticleNo. 99980046/**  
**10kW(2x5.0kW) 208V 50/60 3Phase**

**FOR UNITS BUILT BEFORE 2013**

ITEM	PART #	DESCRIPTION	QTY	CRITICAL
			208V	
1	<a href="#">39333002</a>	Mains Filter 3x30A	1	
2	<a href="#">39500011</a>	Cable Connector Nut (Cable Gland PG21)	1	
3	<a href="#">34260320</a>	Automatic Circuit Breaker	1	
4	<a href="#">39202404</a>	<b>Radial Fan</b>	1	C
5	<a href="#">98012660</a>	<b>Power Board</b>	1	C
6	<a href="#">91131140</a>	CPU Print/Board	1	
7	<a href="#">38640041</a>	Power Cable UL 4 AWG 12 (4mm)	1	
8	<a href="#">32750401</a>	Power Cord Plug USA NEMA 15-30P	1	
9	<a href="#">72142470</a>	Air Deflector	1	
10	<a href="#">71000003</a>	<b>Grease Filter 200x150x12mm</b>	1	
11	<a href="#">72261030</a>	Frame for Grease Filter	1	
12	<a href="#">95000120</a>	<b>Foot Complete Assembly, Adjustable</b>	4	
14	<a href="#">91120030</a>	<b>AC/DC Board (Print I120b)</b>	1	
15	<a href="#">91133120</a>	<b>RTCSmp Dual Cooker Board</b>	1	
16	<a href="#">91109010</a>	<b>(Print I109a) Supply &amp; CAN-BUS Interface Board</b>	1	
17	<a href="#">98300102</a>	Upper S/S Case with Ceran Glass	1	
18	<a href="#">39400001</a>	<b>Plastic Knob 0-12</b>	2	
19	<a href="#">35624009</a>	<b>LED Indicator Light - Green, 24V</b>	2	
20	<a href="#">94010001</a>	<b>Control Switch 2 Pole with Potentiometer</b>	2	C
21	<a href="#">93005030</a>	Coil 5.03 with three PT Sensors	2	
22	<a href="#">94040101</a>	<b>Sensor Unit with three PT Sensors</b>	2	C
23	<a href="#">66000003</a>	Garland Overlay/Label - Dual	1	

\* NOT ILLUSTRATED

**RECOMMENDED STOCK PARTS**

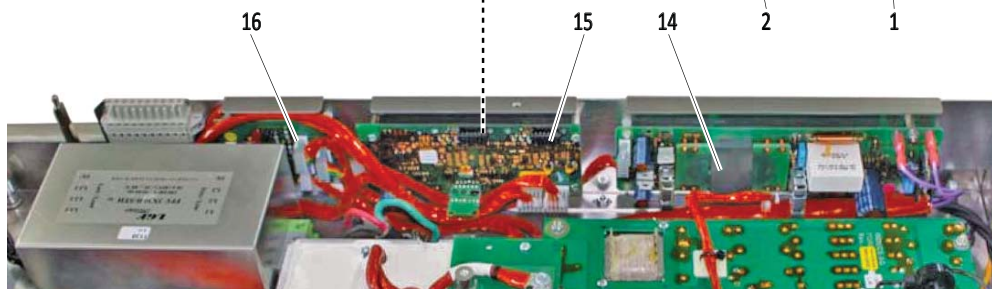
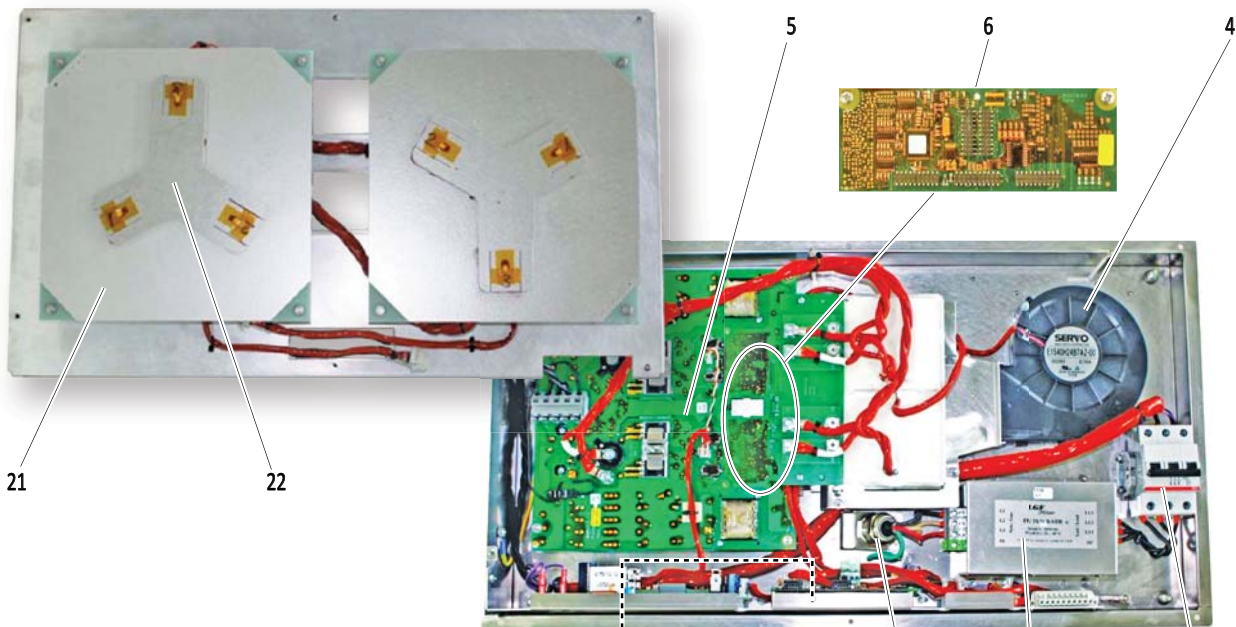







**GARLAND PARTS IDENTIFICATION**  
**RTCSmp Induction Countertop Line, Dual Hobs, 7kW (2x 3.5kW)**  
*220V model*  
**SH DU BA 7000 (2x3500)/ ArticleNo. 99980073/**  
**7kW(2x3.5kW) 220V 50/60Hz 3Phase**

ITEM	PART #	DESCRIPTION	QTY	CRITICAL
			220V	
1	<a href="#">39333002</a>	Mains Filter 3x30A	1	
2	<a href="#">39500011</a>	Cable Connector Nut (Cable Gland PG21)	1	
3	34260320	Automatic Circuit Breaker	1	
4	<a href="#">39202404</a>	<b>Radial Fan</b>	1	C
5	<a href="#">98012660</a>	<b>Power Board</b>	1	C
6	<a href="#">91131110</a>	CPU Print/Board (I131)	1	
7	<a href="#">38640041</a>	Power Cable UL 4 AWG 12 (4mm)	1	
8	<a href="#">32750401</a>	Power Cord Plug USA NEMA 15-30P	1	
9	<a href="#">72142470</a>	Air Deflector	1	
10	<a href="#">71000003</a>	<b>Grease Filter 200x150x12mm</b>	1	
11	<a href="#">72261030</a>	Frame for Grease Filter	1	
12	<a href="#">95000120</a>	<b>Foot Complete Assembly, Adjustable</b>	4	
14	<a href="#">91120030</a>	<b>AC/DC Board (Print I120b)</b>	1	
15	<a href="#">91133120</a>	<b>RTCSmp Dual Cooker Board</b>	1	
16	<a href="#">91109010</a>	<b>(Print I109a) Supply &amp; CAN-BUS Interface Board</b>	1	
17	<a href="#">98300102</a>	Upper S/S Case with Ceran Glass	1	
18	<a href="#">39400001</a>	<b>Plastic Knob 0-12</b>	2	
19	<a href="#">35624009</a>	<b>LED Indicator Light - Green, 24V</b>	2	
20	<a href="#">94010001</a>	<b>Control Switch 2 Pole with Potentiometer</b>	2	C
21	<a href="#">93005030</a>	Coil 5.03 with three PT Sensors	2	
22	<a href="#">94040101</a>	<b>Sensor Unit with three PT Sensors</b>	2	C
23	<a href="#">66000003</a>	Garland Overlay/Label - Dual	1	

\* NOT ILLUSTRATED

**RECOMMENDED STOCK PARTS**

## Repair Accessories

Photo	Part Number	Description
	<a href="#">98990001</a>	IR Adapter Usage: To receive infrared signals from an induction cooker and communicate via a HyperTerminal, or equivalent, on a laptop or other mobile peripherals. Might require additional adaptors (not provided).
	<a href="#">39800001</a>	USB- RS232 Adapter Usage: To connect an IR Adapter ( <a href="#">98990001</a> ) to a computer/device that does not have any RS232 connector.
	<a href="#">70000020</a>	Heat Sink Compound P12. Usage: To mount IGBT or Print/Board onto a Heatsink.
	<a href="#">94900096</a>	Short Circuit (Service) Plug (RTCS only, Not for RTCSmp) Usage: To initialize CU sensors.
(PHOTO UNAVAILABLE)	<a href="#">70000022</a>	High Temperature Tape 16mm Usage, for example: To retain PTC(RTC) sensors; to be used as a temporary adhesive; to be used as a high temperature insulator for coil repair.
	<a href="#">70000015</a>	Silicone Glue PACTAN 7076 (for Installation)
	<a href="#">79000024</a>	Wire Punch Down Tool
	Calibration or Test Plates: Use these plates to calibrate and verify pan detection settings.	
	<a href="#">79000120</a>	Calibration Plate, Ø 120mm, with Handle
	<a href="#">79000100</a>	Calibration Plate, Ø 100mm, with Handle
	<a href="#">79000090</a>	Calibration Plate, Ø 90mm, with Handle
	<a href="#">79000070</a>	Calibration Plate, Ø 70mm, with Handle

**REVISION HISTORY (RTCSmp DUAL HOBS SH DU IN, SH DU BA)**

REV	PAGE / MODEL	ITEM#	NOTES	DATE	BY
0	99980073		New Release	7 OCT/11	HH
1			Added "GI" prefix to model designation.	4 JAN/12	HH
	99980073	6	Added part - CPU Print <a href="#">91131110</a>		HH
	99980073	5,20	New P/N <a href="#">98012660</a> replaced <a href="#">98012630</a> . New P/N <a href="#">94010001</a> replaced <a href="#">94010000/</a>		HH
2	99980046		Added new model 9998846	10 FEB/12	HH
3	99980073	12	Foot Asm <a href="#">95000120</a> replaced 71000006, 61421201	25 JUL/12	HH
4	99580101, 99580103 99580104, 99580105 99580107, 99580108 99560201, 99560203 99560204, 99560205 99560207, 99560208		New models	30 MAY/14	HH
	99980073, 99980046		GI prefix no longer used for Model Numbers. Old models. Exact UP TO Dates/Serial#s have not been confirmed.		
			Added repair accessories list. Added rating plate location, searial and model number information.		
5			New KitchenCare front and back covers, footer.	26 NOV/14	HH
	ALL SH/DU/IN	19, 34	Added items to parts table.		
	16		Added more accessories		



1-844-724-CARE • [www.mtwkitchencare.com](http://www.mtwkitchencare.com)