

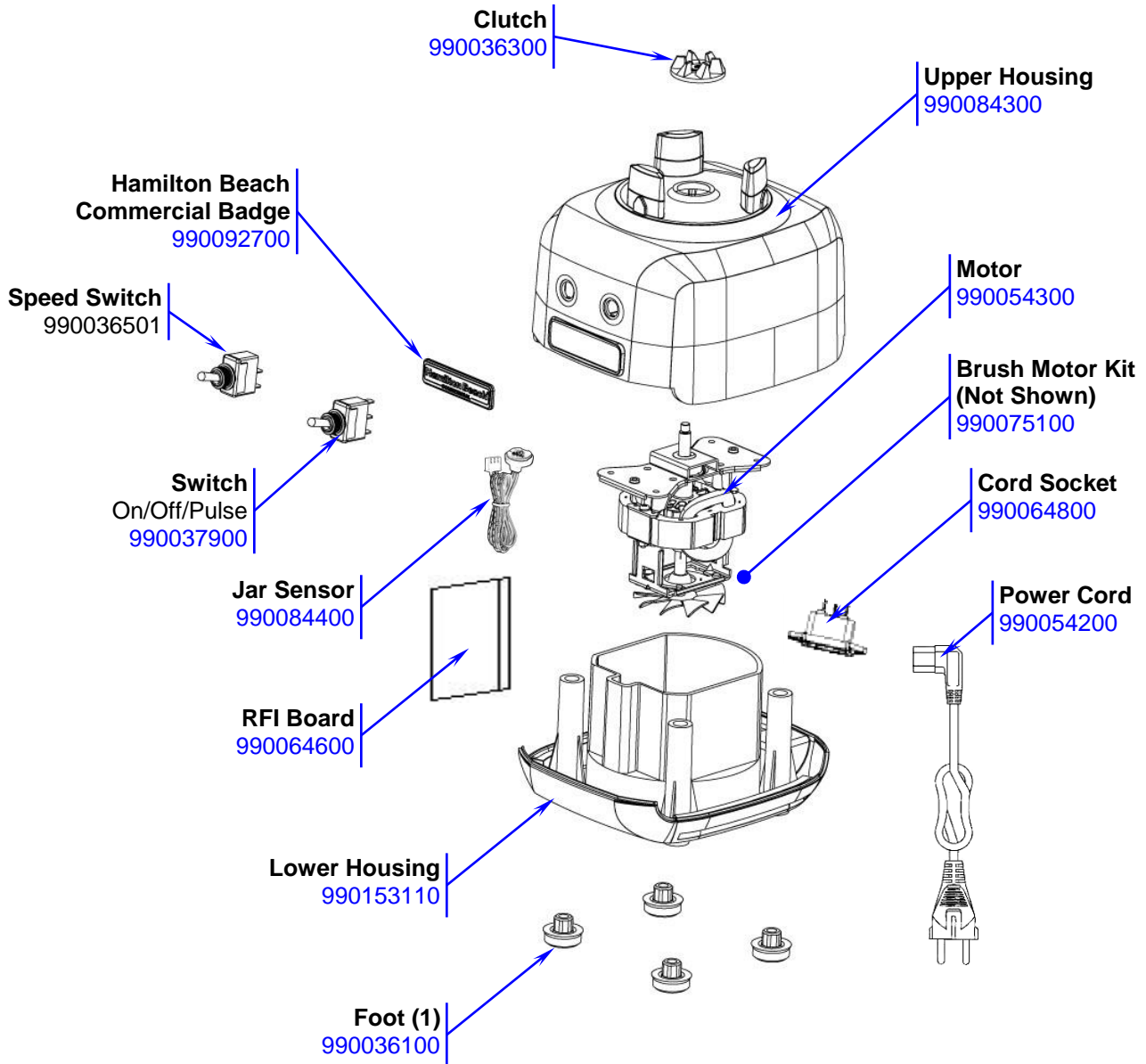

Parts and Accessories Diagram

Model HBB250S-CE

PROPRIETARY RIGHTS NOTICE This document and all information contained within it is the property of Hamilton Beach Brands, Inc. (HBB). It is confidential and proprietary and has been provided to you for a limited purpose. It must be returned or destroyed upon request. Disclosure, reproduction or use of this document and any information contained within it, in full or in part, for any purpose is forbidden without the prior written consent of HBB. No photographs may be taken of any article fabricated or assembled from this document without the prior written consent of HBB.

Replacement Parts



 <p>4421 Waterfront Drive Glen Allen, VA 23060</p>	Revision	Create New CARE Part					Rev. Date:	
	Description:						Request #:	DOC10882
							Rev:	D

Parts and Accessories Diagram

Model HBB250S-CE

PROPRIETARY RIGHTS NOTICE This document and all information contained within it is the property of Hamilton Beach Brands, Inc. (HBB). It is confidential and proprietary and has been provided to you for a limited purpose. It must be returned or destroyed upon request. Disclosure, reproduction or use of this document and any information contained within it, in full or in part, for any purpose is forbidden without the prior written consent of HBB. No photographs may be taken of any article fabricated or assembled from this document without the prior written consent of HBB.

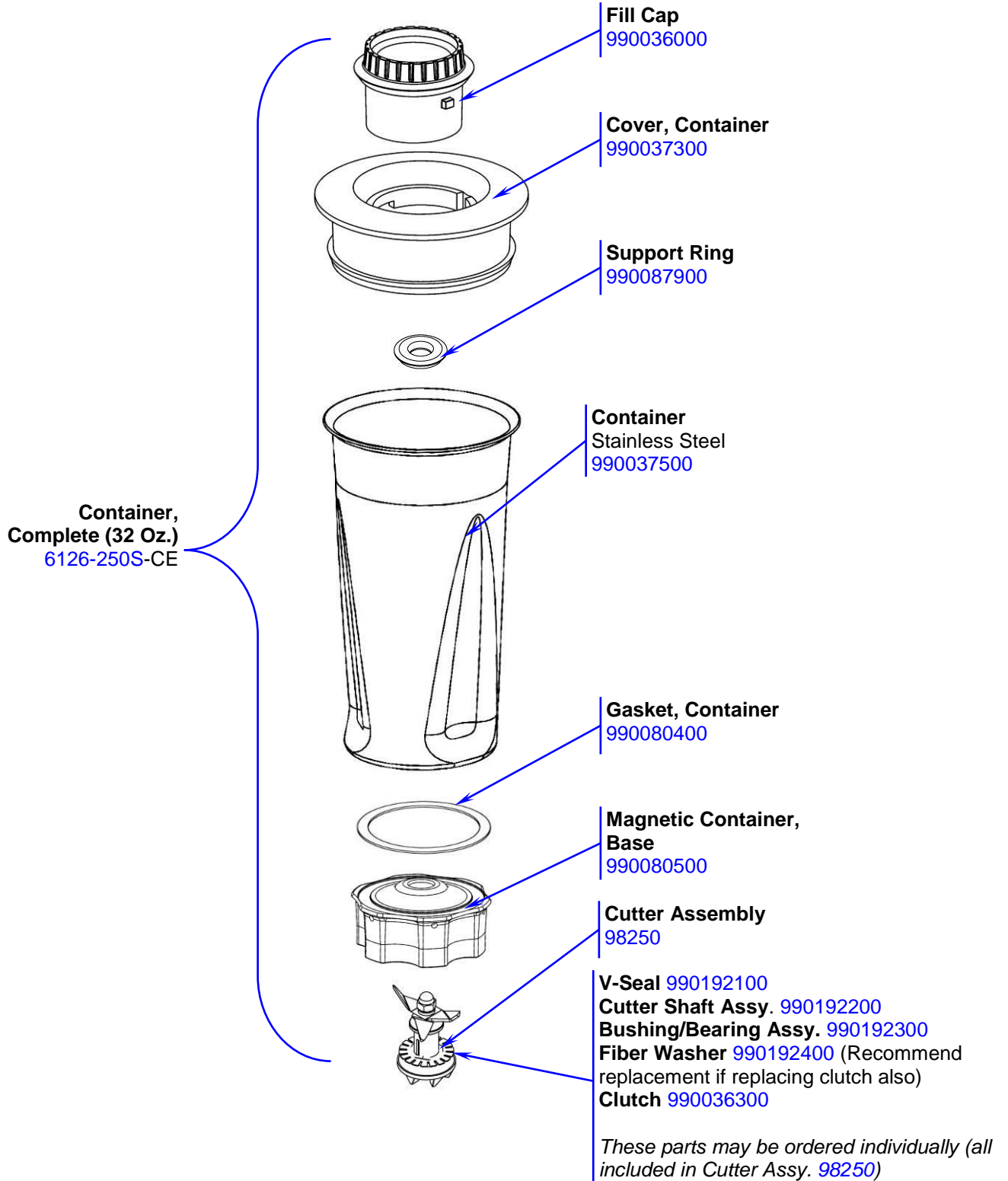

 4421 Waterfront Drive Glen Allen, VA 23060	Revision	Create New CARE Part					Rev. Date:
	Description:						03/23/2020
Request #:	DOC10882	Page:	2 of 5	Document #:	540030000	Rev:	D

Parts and Accessories Diagram

Model HBB250S-CE

PROPRIETARY RIGHTS NOTICE This document and all information contained within it is the property of Hamilton Beach Brands, Inc. (HBB). It is confidential and proprietary and has been provided to you for a limited purpose. It must be returned or destroyed upon request. Disclosure, reproduction or use of this document and any information contained within it, in full or in part, for any purpose is forbidden without the prior written consent of HBB. No photographs may be taken of any article fabricated or assembled from this document without the prior written consent of HBB.

Cutter Assembly Replacement Instructions

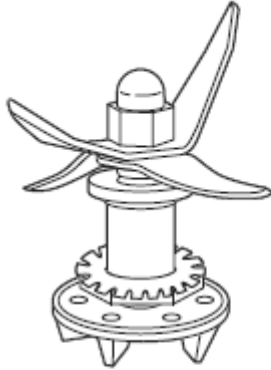

Cutter Repair Kit
for Rio Blenders



⚠ WARNING



Cut Hazard
Handle cutter
assembly with
care.
Failure to follow
these instructions
can result in cuts
or other injuries.

Removing the old cutter assembly

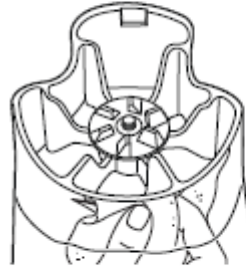

Hold the blades with a cloth. Unscrew the clutch counterclockwise.

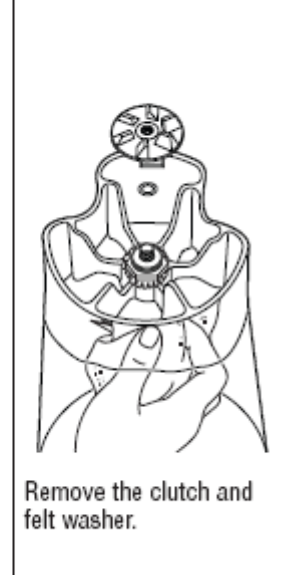

Remove the clutch and felt washer.



Remove the shaft and blade assembly

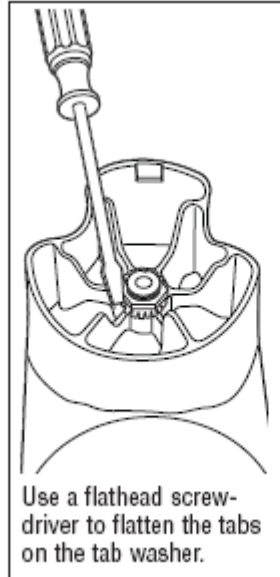

Use a flathead screwdriver to flatten the tabs on the tab washer.

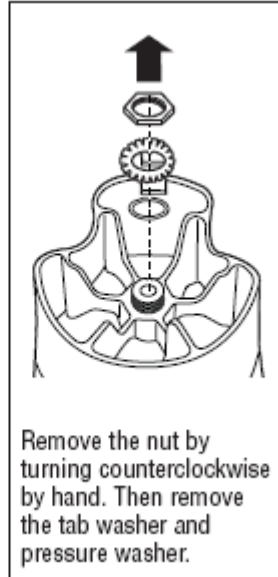

Remove the nut by turning counterclockwise by hand. Then remove the tab washer and pressure washer.

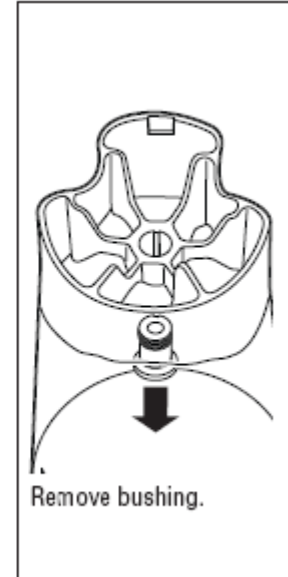

Remove bushing.

4421 Waterfront Drive Glen Allen, VA 23060	Revision	Create New CARE Part				Rev. Date:
	Description:					03/23/2020
Request #:	DOC10882	Page:	3 of 5	Document #:	540030000	Rev: D

Parts and Accessories Diagram

Model HBB250S-CE

PROPRIETARY RIGHTS NOTICE This document and all information contained within it is the property of Hamilton Beach Brands, Inc. (HBB). It is confidential and proprietary and has been provided to you for a limited purpose. It must be returned or destroyed upon request. Disclosure, reproduction or use of this document and any information contained within it, in full or in part, for any purpose is forbidden without the prior written consent of HBB. No photographs may be taken of any article fabricated or assembled from this document without the prior written consent of HBB.

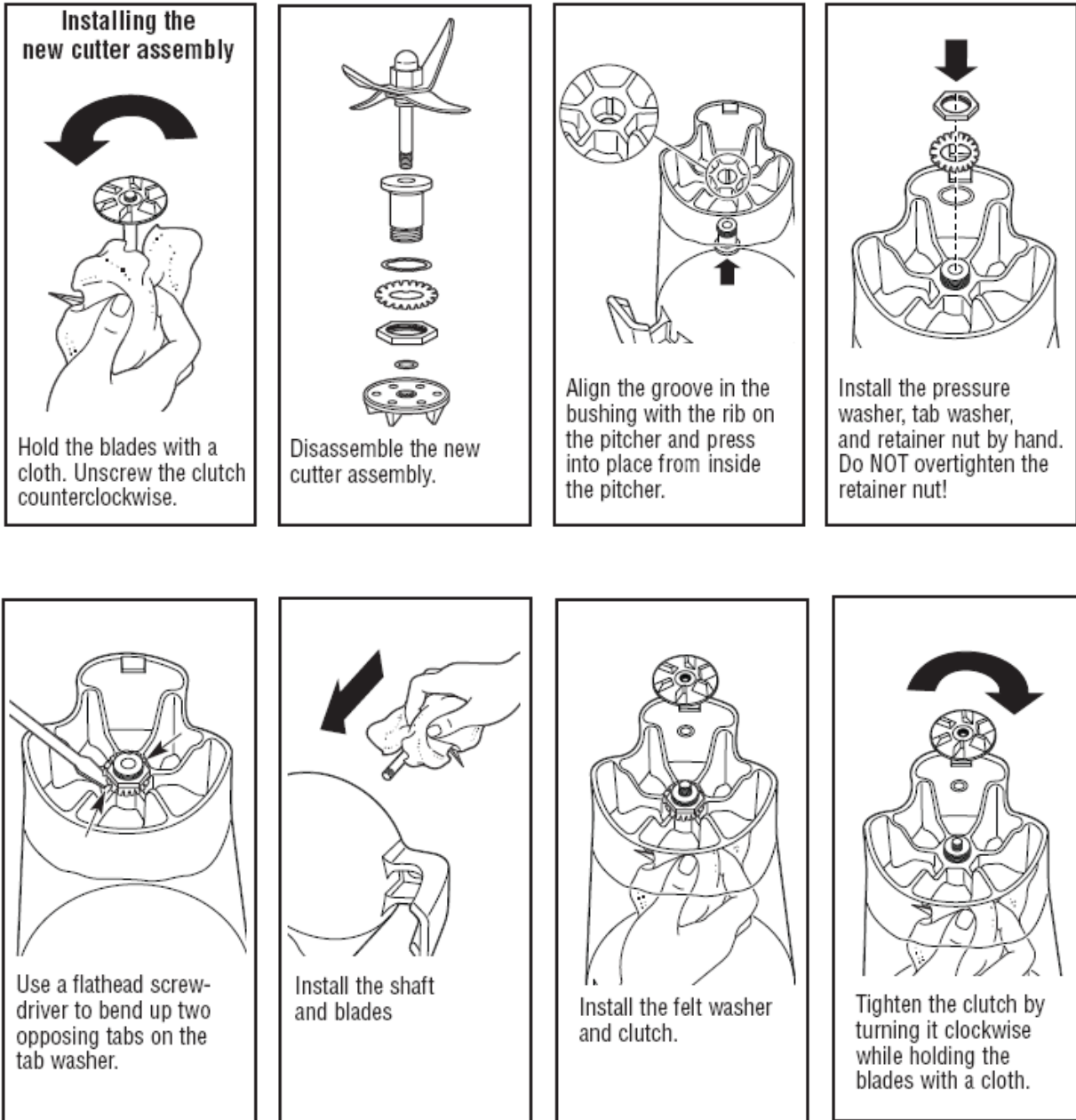

4421 Waterfront Drive Glen Allen, VA 23060	Revision	Create New CARE Part				Rev. Date:
	Description:					03/23/2020
Request #:	DOC10882	Page:	4 of 5	Document #:	540030000	Rev: D

Parts and Accessories Diagram

Model HBB250S-CE

PROPRIETARY RIGHTS NOTICE This document and all information contained within it is the property of Hamilton Beach Brands, Inc. (HBB). It is confidential and proprietary and has been provided to you for a limited purpose. It must be returned or destroyed upon request. Disclosure, reproduction or use of this document and any information contained within it, in full or in part, for any purpose is forbidden without the prior written consent of HBB. No photographs may be taken of any article fabricated or assembled from this document without the prior written consent of HBB.

Accessories

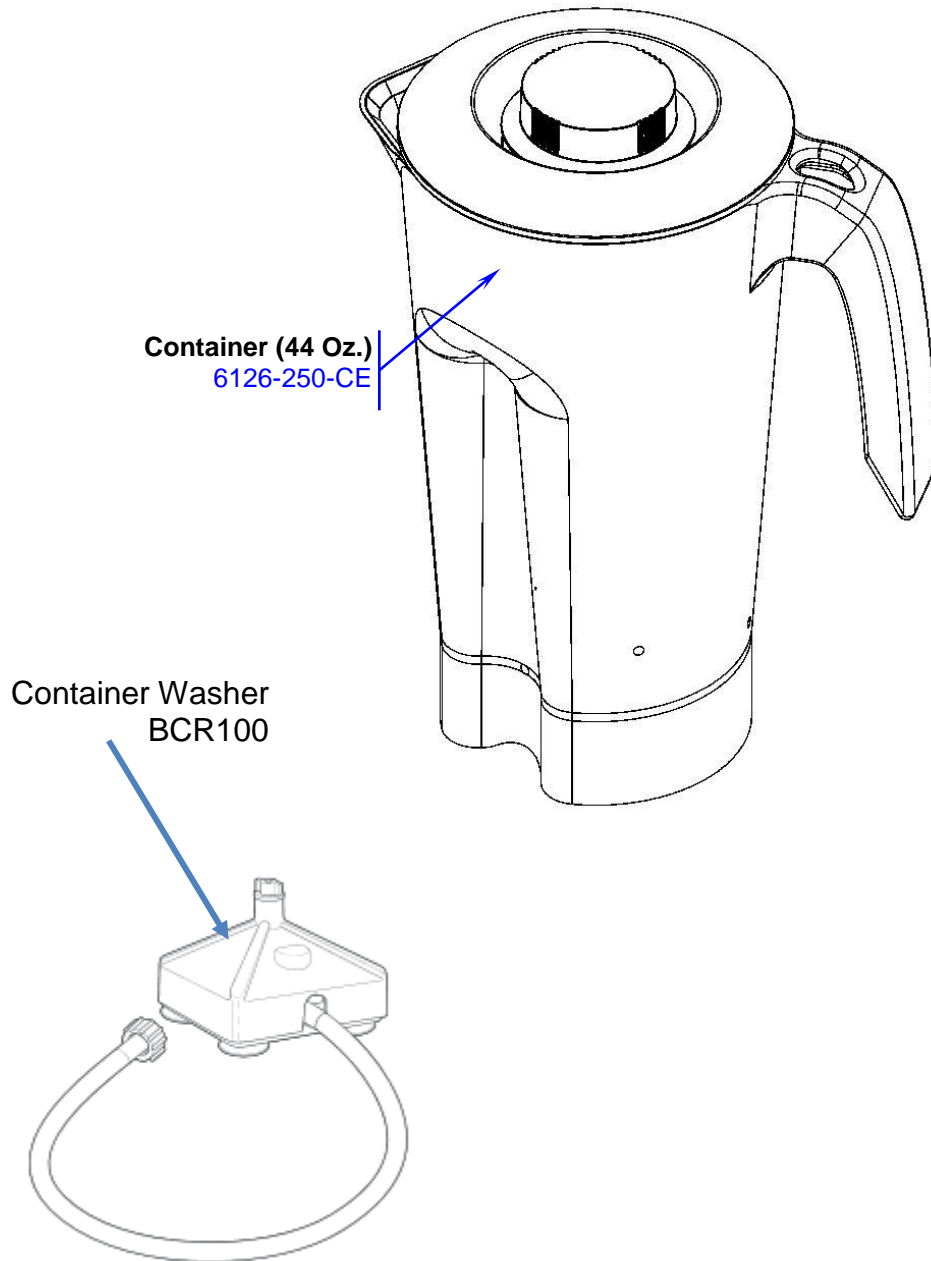

4421 Waterfront Drive Glen Allen, VA 23060	Revision	Create New CARE Part					Rev. Date:
	Description:						03/23/2020
Request #:	DOC10882	Page:	5 of 5	Document #:	540030000	Rev:	D