

Parts and Accessories Diagram

HMD200

PROPRIETARY RIGHTS NOTICE This document and all information contained within it is the property of Hamilton Beach Brands, Inc. (HBB). It is confidential and proprietary and has been provided to you for a limited purpose. It must be returned or destroyed upon request. Disclosure, reproduction or use of this document and any information contained within it, in full or in part, for any purpose is forbidden without the prior written consent of HBB. No photographs may be taken of any article fabricated or assembled from this document without the prior written consent of HBB.

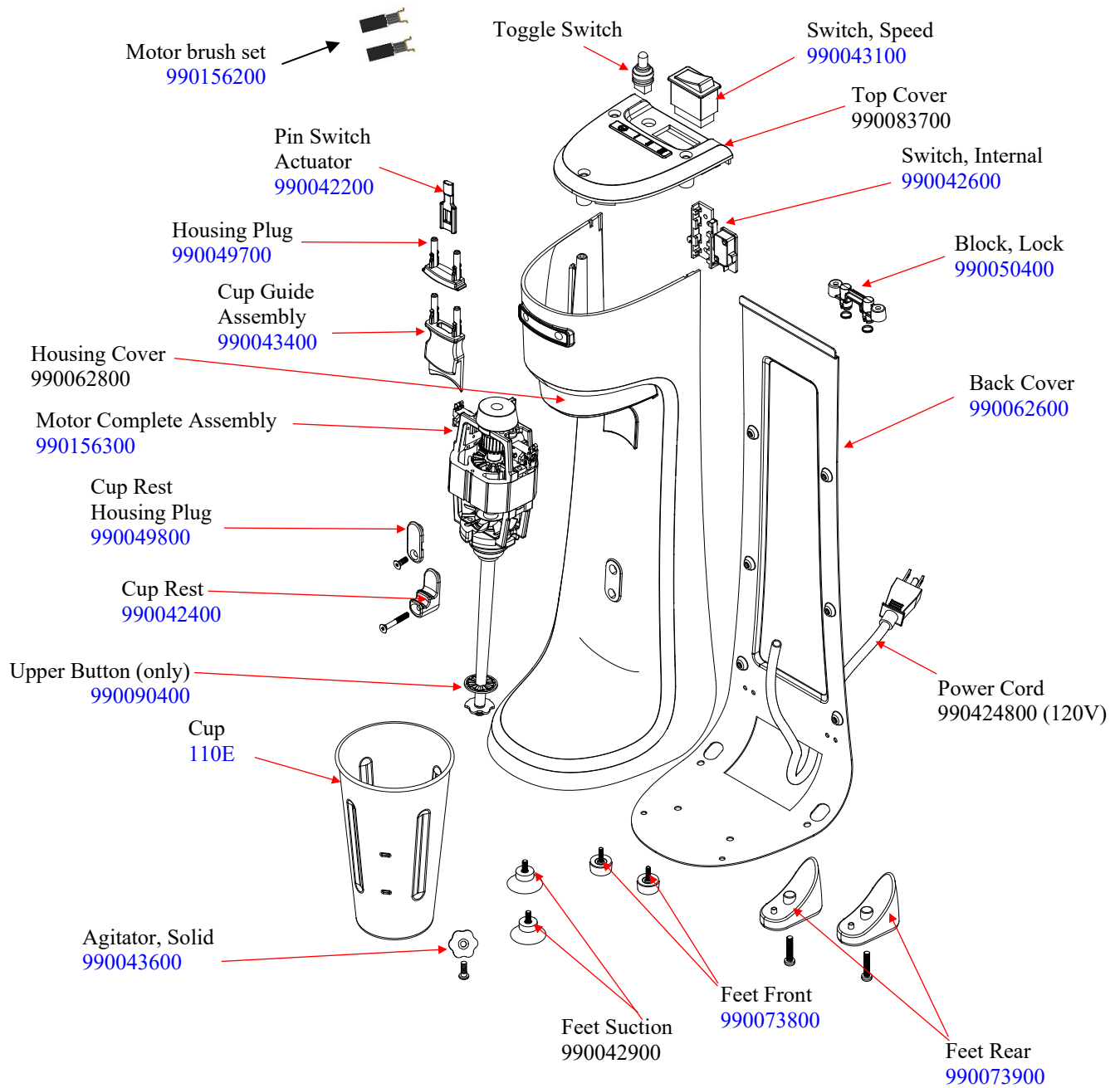

Note: Use toggle switch **990043000** on Series A-D machines and the top cover must be changed also to **990062200**.

*Switch Upgrade Kit for series A-D – **990092800**
Includes: Upper Lid, Toggle Switch, Boot, Grounding Wire, and Switch Adaptor

 4421 Waterfront Drive Glen Allen, VA 23060	Revision	Update Power Cord Part number				Rev. Date:
	Description:	DOC14038	Page:	1 of 3	Document #:	7/2/2024
Request #:	DOC14038	Page:	1 of 3	Document #:	510021100	Rev: F

Parts and Accessories Diagram

HMD200

PROPRIETARY RIGHTS NOTICE This document and all information contained within it is the property of Hamilton Beach Brands, Inc. (HBB). It is confidential and proprietary and has been provided to you for a limited purpose. It must be returned or destroyed upon request. Disclosure, reproduction or use of this document and any information contained within it, in full or in part, for any purpose is forbidden without the prior written consent of HBB. No photographs may be taken of any article fabricated or assembled from this document without the prior written consent of HBB.

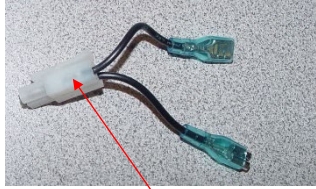

Switch Adaptor
990088900

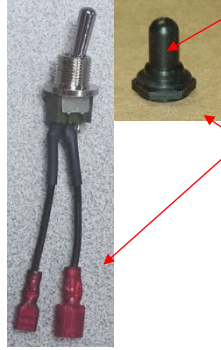

Boot
990084200

Toggle Switch, Boot and Lead Wires
– Sub-Assembly
990083600

Ground Wire, Gasket
and Ground Wire
990088800



 4421 Waterfront Drive Glen Allen, VA 23060	Revision	Update Power Cord Part number					Rev. Date:
	Description:						7/2/2024
Request #:	DOC14038	Page:	2 of 3	Document #:	510021100	Rev:	F

Parts and Accessories Diagram

HMD200

PROPRIETARY RIGHTS NOTICE This document and all information contained within it is the property of Hamilton Beach Brands, Inc. (HBB). It is confidential and proprietary and has been provided to you for a limited purpose. It must be returned or destroyed upon request. Disclosure, reproduction or use of this document and any information contained within it, in full or in part, for any purpose is forbidden without the prior written consent of HBB. No photographs may be taken of any article fabricated or assembled from this document without the prior written consent of HBB.

Accessories

Agitator,
Alternative
929

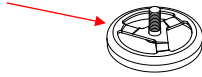

Hamilton Beach 4421 Waterfront Drive Glen Allen, VA 23060	Revision	Update Power Cord Part number					Rev. Date:	
	Description:						7/2/2024	
	Request #:	DOC14038	Page:	3 of 3	Document #:	510021100	Rev:	F