

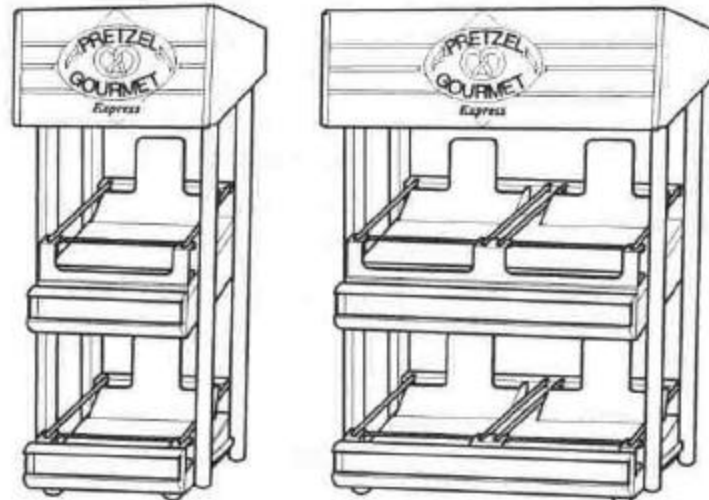

OPERATING INSTRUCTIONS & REPLACEMENT PARTS LIST



J&J PRETZEL DISPLAY WARMER

MODELS:

GRPDS-11D

GRPDS-20D

 **Installation, maintenance and repair to be performed by qualified service personnel only.**

SAFETY PRECAUTIONS

A Plug unit into an electrical outlet of the correct volt-¹ age, size and plug configuration. If the plug and receptacle do not match, contact a qualified electrician to determine the proper voltage and size and install the proper electrical outlet.

 To prevent electrical shock, always unplug the unit before performing cleaning, maintenance or repair.

 Some exterior surfaces on the unit will get hot. Use caution when touching these areas to avoid injury.

 For safe and proper operation, the unit must be located a reasonable distance from combustible walls and materials. If safe distances are not maintained, discoloration or combustion could occur.

ELECTRICAL SPECIFICATIONS

Model	Voltage	Wattage	Amps	Plug Configuration	Ship Weight
GRPDS11D	120	345	2.9	NEMA 5-15P	82 lbs.(37
GRPDS20D	120	680	5.7	NEMA 5-15P	82 kg) lbs.(37

DIMENSIONS

GRPDS-11 D: 28 3/4" H x 11"W x 18 1/2"-D (73 x 28 x 47 cm)
GRPDS-20D: 28 3/4" H x 20"W x 18 1/2"D (73 x 51 x 47 cm)

INSTALLATION

1. Unpack and unwrap all parts.
2. With the glass sides secured, carefully position unit on its side and thread the four(4) rubber feet into the bottom base holes provided. Return unit to upright position.
3. Remove protective film from all surfaces.

NOTE: Do not remove the 1/2" (2 cm) teflon slider strips on the bottom side of the pretzel sled.

4. Install the thumb screws, four (4) per tier, into the holes provided on black hardcoat surface.

NOTE: Do NOT tighten.

5. Place the front pretzel stop with keyhole slots over the head of the thumb screw. The narrow section of the keyhole slot must be pointing towards the rear of the unit. Slide the pretzel stop forward until the narrow section is under the shoulder of the thumb screw. Tighten the thumb screws.
6. Wipe off the teflon sliders on the bottom of the sled, then position the sled(s) on the black hardcoat surface so the slanted face of the sled is aimed toward the front side of the unit.

NOTE: The sled will slide easier with each use.

7. Place the rear pretzel stop with keyhole slots over the head of the thumb screw. The narrow section of the key hole slot must be pointed towards the rear of the unit.
8. Install the shelf divider rods in the slots provided in the front and rear pretzel stops.
9. When the divider rods are in place, slide the rear pretzel stop forward until the narrow section is under the shoulder of the thumb screw. Tightening of the thumb screws will hold the pretzel stop in place and "lock in" the divider rods.
10. Install top sign onto canopy by gently bending it end to end and snap it into place behind the bracket on each side of the canopy.
11. Install the "pretzel flavor" signs by sliding them into the end of each bullnose section on the front of each shelf.

OPERATION

The Pretzel Display Warmer is controlled by the on/off switch located on the back of the unit. The switch must be in the "ON" position for the unit to function. Allow 35-40 minutes for warmup.

 Remove protective film from all surfaces before turning unit on.

Load bagged pretzels into the unit by placing them between the slide and front stop. When front pretzels are removed, the remaining pretzels will be pushed forward by the weighted sled.

MAINTENANCE

The Hatco Pretzel Display Warmers are designed for maximum durability and performance with minimum maintenance.

To avoid injury, turn the power switch off, unplug the unit from the power source and allow to cool before performing any maintenance.

CLEANING

To preserve the finish of your unit, it is recommended that the exterior and interior surfaces be wiped daily with a damp cloth. Stubborn stains may be removed with a non-abrasive, mild cleaner.

 Use only non-abrasive cleaners. Abrasive cleaners could scratch the finish of your warmer marring its appearance and making it susceptible to soil accumulations.

CANOPY - To remove the canopy for cleaning, remove the sign in the front by bending it slightly to disengage it from the brackets on either end. Remove the two thumb screws (located behind the sign position) and slide the canopy back to disengage the shoulder bolts. Lift the rear of the canopy and slide forward and up to remove. Reverse this procedure to reinstall.

GLASS - Clean the glass sides using a common glass cleaner.

Model GRPDS

! Only bulbs which meet or exceed N.S.F. standards, specifically designed for food holding areas must be used. Breakage of bulbs not specially coated could result in personal injury and /or food contamination.

To remove the glass sides, turn the unit off and wait until it is cool. Place one hand on the inside against the glass and the other hand on the outside against the glass. Lift the glass upward and then outward away from the unit following the glass to be removed from the channel. Reverse this procedure to reinstall.

DISPLAY LIGHT BULB REPLACEMENT - The display lights are incandescent 60 watt light bulbs which illuminate and warm the product area. These bulbs have a special coating to guard against injury and food contamination in the event of breakage.

To replace a light bulb, disconnect the power supply and wait until the unit has cooled. Unscrew the light bulb from the unit and replace it with a new specially coated incandescent bulb.

NOTE: Hatco shatter-resistance light bulbs meet N.S.F. standards for food holding and display areas. For 120 volt applications, use Hatco part #02.30.043.00.

OPTIONAL ACCESSORIES (Not shipped with unit)

SNEEZE GUARD - A sneeze guard can be attached to each tier if needed or required by local health codes.

FLIP UP DOORS - These doors are available for the back of each tier. The doors reduce air movement through the unit, thereby keeping the pretzels warmer. Ideal for locations having excess air movements from door openings, exhaust fans, air conditioning vents, etc.

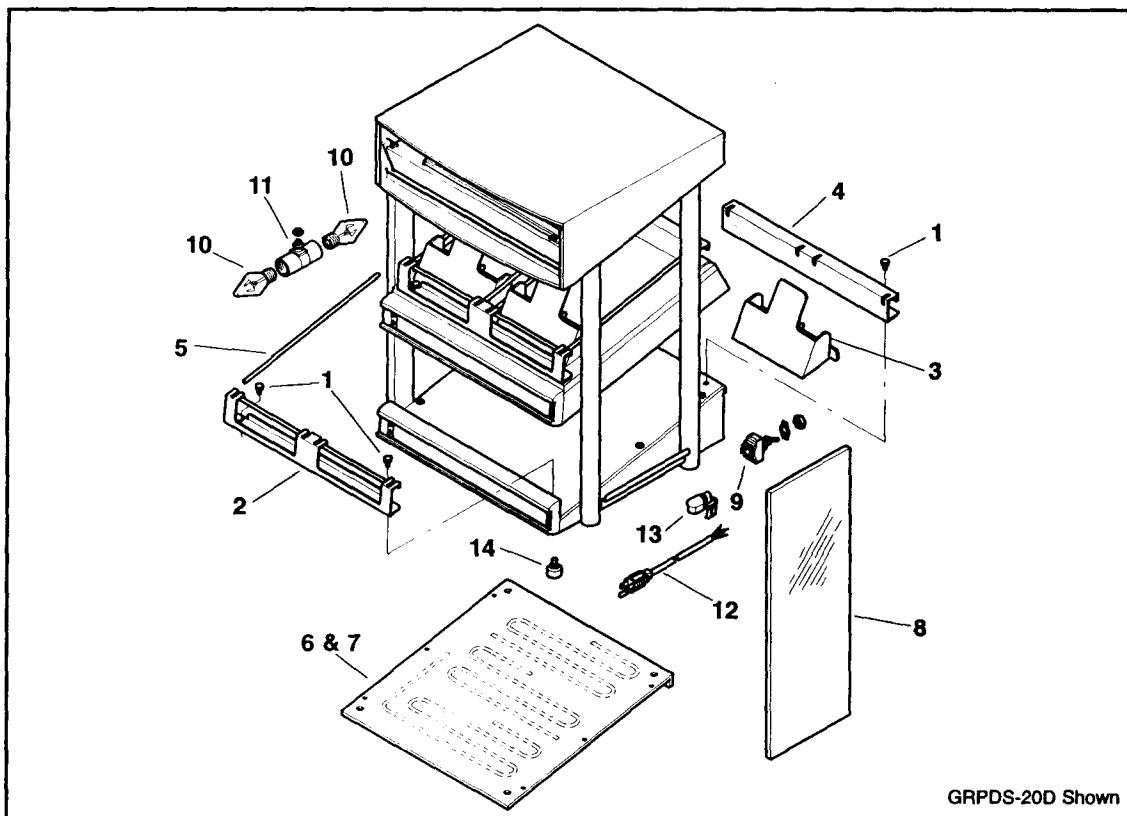

GRPDS-20D Shown

Item	Description	Part No.	Qty.	Item Description	Part No.	Qty.
			HP 20D			11D 20D
1.	Thumb Screw	05.04.305.00	8	9. On/Off Toggle Switch	02.19.016.00	1 1
2.	Front Pretzel Stop	04.14.109.00	2	10. Light Bulb 60 Watt	02.30.043.00	5 10
3.	Pretzel Sled Assembly	04.14.112.00	2	11. Light Socket	02.30.045.00	2 5
4.	Rear Pretzel Stop	04.14.104.00	2	12. Power Cord with Plug	R02.18.030.00	1 1
5.	Divider Rods	04.14.110.00	4	13. Cord Grip	02.20.206.00	1 1
6.	Base Blanket Element BOW	02.05.322.00	1	14. Rubber Foot	05.30.044.00	4 4
7.	Shelf Blanket Element SOW	02.05.323.00	1			
8.	Glass Side Panel	04.40.108.00	2			

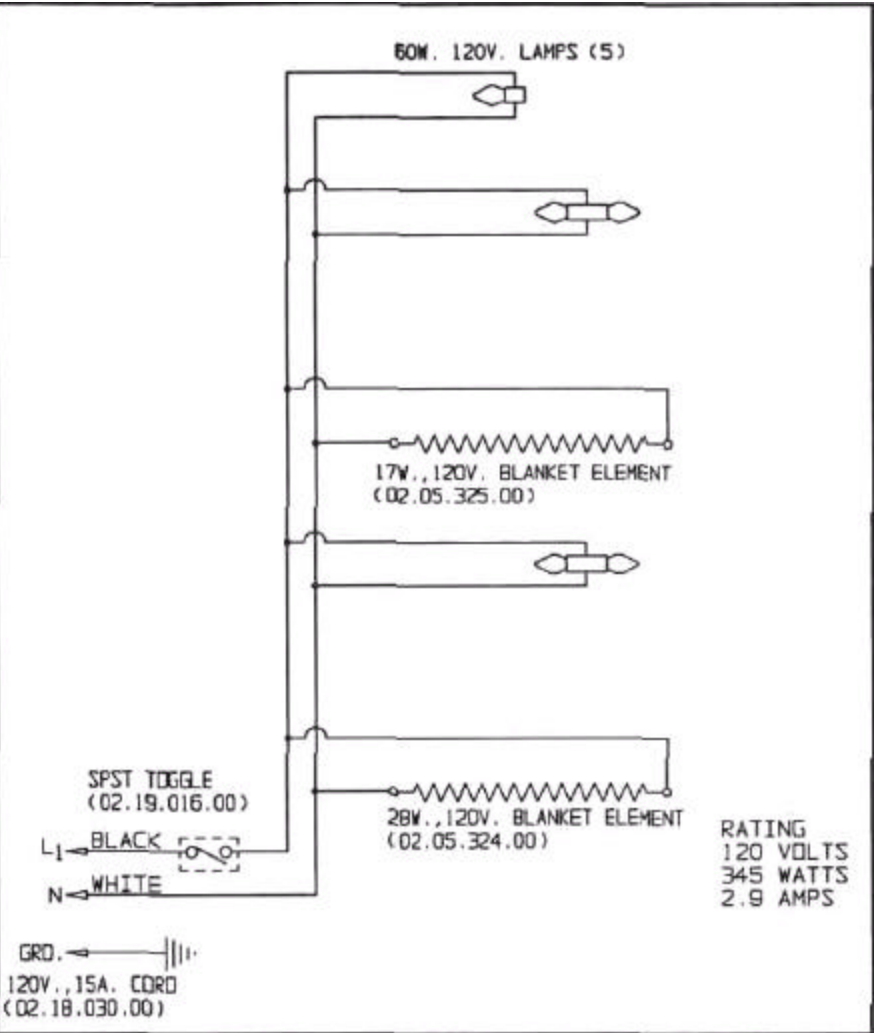

GRPDS-11D
Wiring Diagram

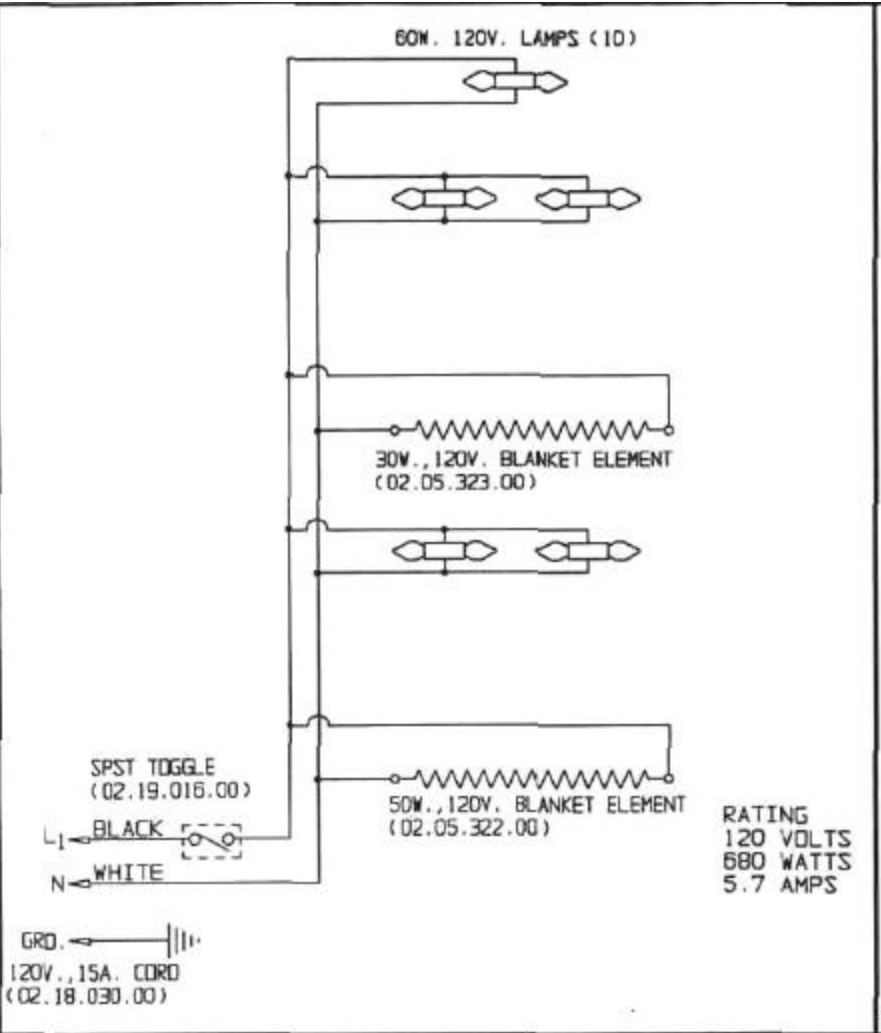

GRPDS-20D
Wiring Diagram

HATCO CORPORATION

P.O. Box 340500, Milwaukee, WI 53234-0500 U.S.A.

(800) 558-0607 (414) 671-6350 Parts & Service Fax (800) 690-2966 Int'l. Fax (414) 671-3976

Web Site: <http://www.hatcocorp.com>