

INSTALLATION and OPERATION INSTRUCTIONS

FlatTop Bottle Coolers

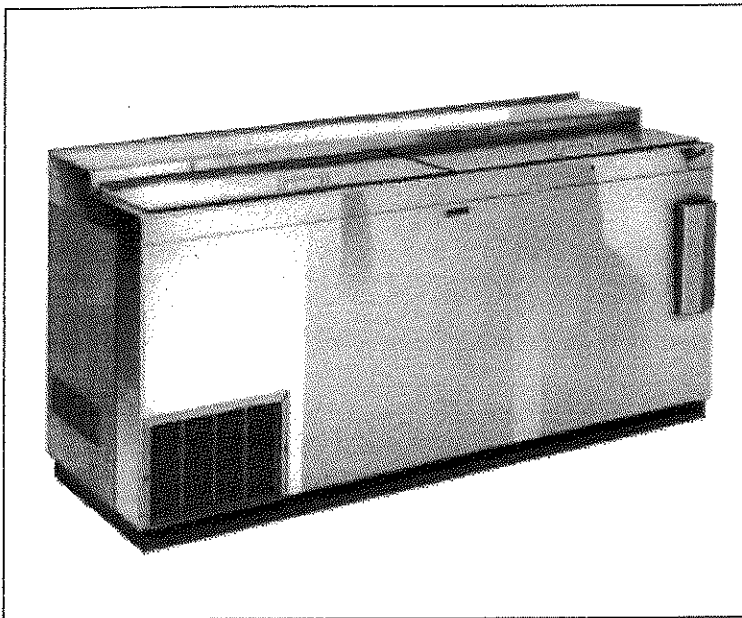

Model Nos.
7260E230 Series
7262D230 Series
7264-230 Series

*Carries CE
Marking of Conformity*

Table of Contents

Installing

Adjusting Partitions	2
Backsplash	2
Placing and Leveling	2
Sealing to the Floor	2
Temperature Control	3
Removing Sliding Doors	3
Cleaning	3
Replacement Parts	4
Wiring Diagram	5

IMPORTANT WARRANTY INFORMATION

A Warranty card is enclosed that must be completed and mailed to the Perlick Corporation to register the warranty. If the card is not returned to Perlick, the warranty period will begin from the date the equipment is shipped from the factory.

This manual has been prepared to assist you in the installation of your Bottle Cooler and to acquaint you with its operation and maintenance.

We dedicate considerable time to ensure that our products provide the highest level of customer satisfaction. If service is required, your dealer can provide you with a list of qualified service agents. For your own protection, never return merchandise for credit without our approval.

We thank you for selecting a Perlick product and assure you of our continuing interest in your satisfaction.



8300 West Good Hope Road
Milwaukee, WI 53223
Phone: 414-353-7060 Fax: 414-353-7069

PLUMBING

No plumbing connections are required. Liquid from the cooling coil automatically evaporates through a condensate pan located in the condensing unit section.

ELECTRICAL

Electric connection to the cabinet is through an Interpower™ IEC320 Power Inlet. Wiring must be done in accordance with all local and national requirements.

Caution: Do not attempt to operate the equipment on any other power source than that listed on the Electrical Specification Plate.

ADJUSTABLE PARTITIONS

Perlick Bottle Coolers are provided with adjustable partitions which will accommodate various bottle sizes.

- Remove bottles from their cases before placing in cooler to ensure proper air flow.

INSTALLING BACKSPLASH (optional)

- Position bottle cooler backsplash on top as shown. Use holes in backsplash as a guide to mark and drill $\frac{1}{8}$ " diameter holes into cabinet top.
- Place adjoining equipment to side(s) of bottle cooler and fasten using $\frac{1}{2}$ " x #10 x sheet metal screws and #10 speed nut.

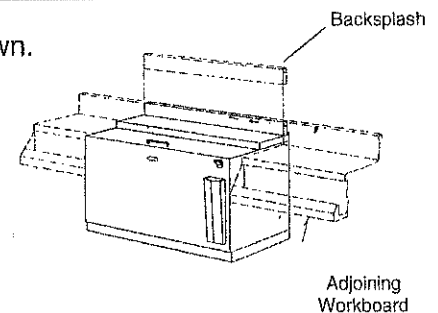

PLACING the CABINET

To assure maximum performance, fresh air must be allowed to circulate through the machinery compartment. It is important to allow at least two inches of clearance at the back or left end of the cabinet. Do not place anything on the top or in front of the cabinet that would obstruct air flow at these grilles.

Cabinet should either be leveled or pitched slightly toward the drain to allow any accumulated water to flow out.

For sanitation purposes, it may be necessary to seal the base of the cabinet to the floor. This can be done by laying a bead of silicone sealant along the base of the cabinet as shown by the figure to the right.

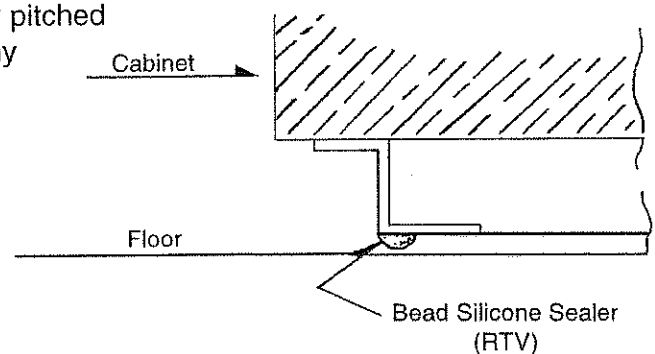

TEMPERATURE CONTROL

An adjustable temperature control is located inside the bottle cooler on the evaporator fan panel assembly. It is factory set at approximately 3° C. Make adjustments as shown to attain the desired temperature.

Note: A temperature setting that is too low will not allow enough condensing unit "off" time to maintain a frost-free coil.

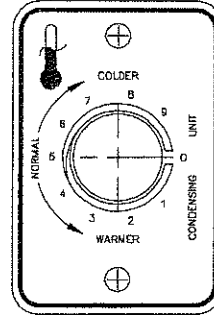

CLEANING

Condenser

The condenser (located behind the front grille) should be inspected every 30 days, and cleaned, if necessary. Failure to keep the condenser clean will cause a loss in condensing unit efficiency.

Doors

Doors should be periodically removed from the cabinet and inspected for a buildup of foreign materials, such as syrups, beer, etc. Buildups on the underside of the doors, along with the cabinet breaker strips on which they ride, will cause them to bind, and therefore, not function as designed. If dirty, these surfaces should be cleaned with a silicone lubricating material. Aerosol silicone sprays can be obtained locally at most department or automotive stores.

To remove doors: With door closed, lift it upward by its handle and slide forward until door clears the cabinet top. Use the reverse procedure to reinstall the doors.

Cabinet

Use a damp cloth with a mild detergent and water to clean the inside and outside of the cabinet. Dry thoroughly. Do not allow cleaning agents or large amounts of water to go down the drain. Use an acceptable stainless steel polish to clean all stainless steel surfaces.

REPLACEMENT PARTS

FLAT TOP BOTTLE COOLERS

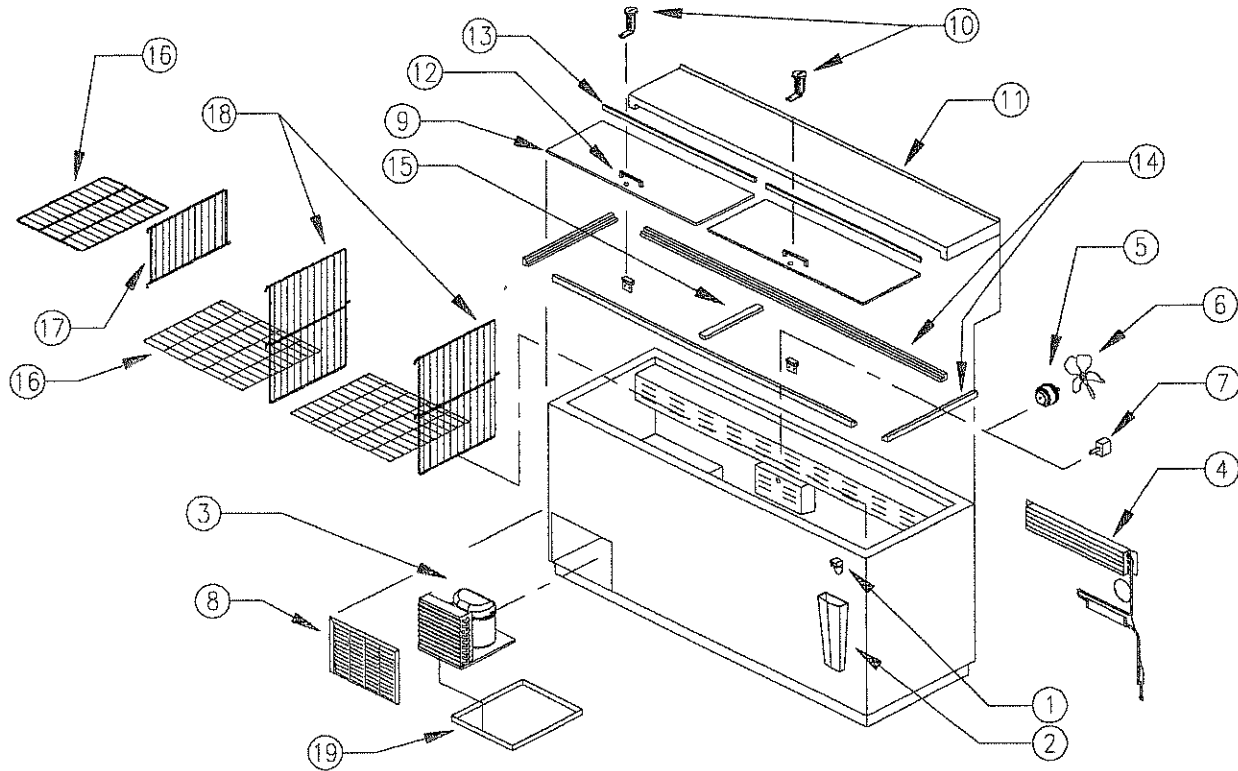

Item No.	Model No.7260E	Model No.7262D	Model No.7264	Description
1	C15909	C15909	C15909	Cap Opener
2	C17332AL	C17332AL	C17332AL	Cap Receiver (Aluminum)
2	C17332BL	C17332BL	C17332BL	Cap Receiver (Black)
2	C17332SS	C17332SS	C17332SS	Cap Receiver (Stainless Steel)
3	C22621	C22620	C22620	Condensing Unit (R134a)
4	C29859	C29862	C30282	Fin coil w/liquid & suction line (R134a)
5	C27959	C27959	C27959	Evaporator Fan Motor
6	C6147	C6147	C6147	Evaporator Fan Blade
7	61271	61271	61271	Temperature Control
8	C29839-1P	C29839-1P	C29839-1P	Front Grille - Painted
8	C29839-2SS	C29839-2SS	C29839-2SS	Front Grille - Stainless
9	C30878	C29811	C30288	Door Assembly
10	C5950R	C5950R	C5950R	Door Lock
11	C29822	C29819	C30284	Back Top Assembly
12	C15817	C15817	C15817	Door Handle
13	C27941-1	C27941-2	C27941-4	Top Wiper Gasket
14	C31705A	C31706A	C31707A	Breaker Strip Kit
15	C25539	C25539	C25539	Center Mullion Assembly
16	C31086	C31087	C31317	Set of Floor Racks
17	C29843-1	C29843-1	C29843-1	Left Partition
18	C29842-1	C29842-1	C29842-1	Main Partition
19	C29872	C29872	C29872	Condensate Pan

WIRING DIAGRAM

FLAT TOP BOTTLE COOLERS

