

31 BRAMSTEELE ROAD
BRAMPTON, ONTARIO
L6W 3K6

QBD® Cooling Systems Inc.

TEL: (905) 459-0709 COOLER:
FAX: (905) 459-1478 DC10HB 34-9518-XXXXL1 120V, 60Hz

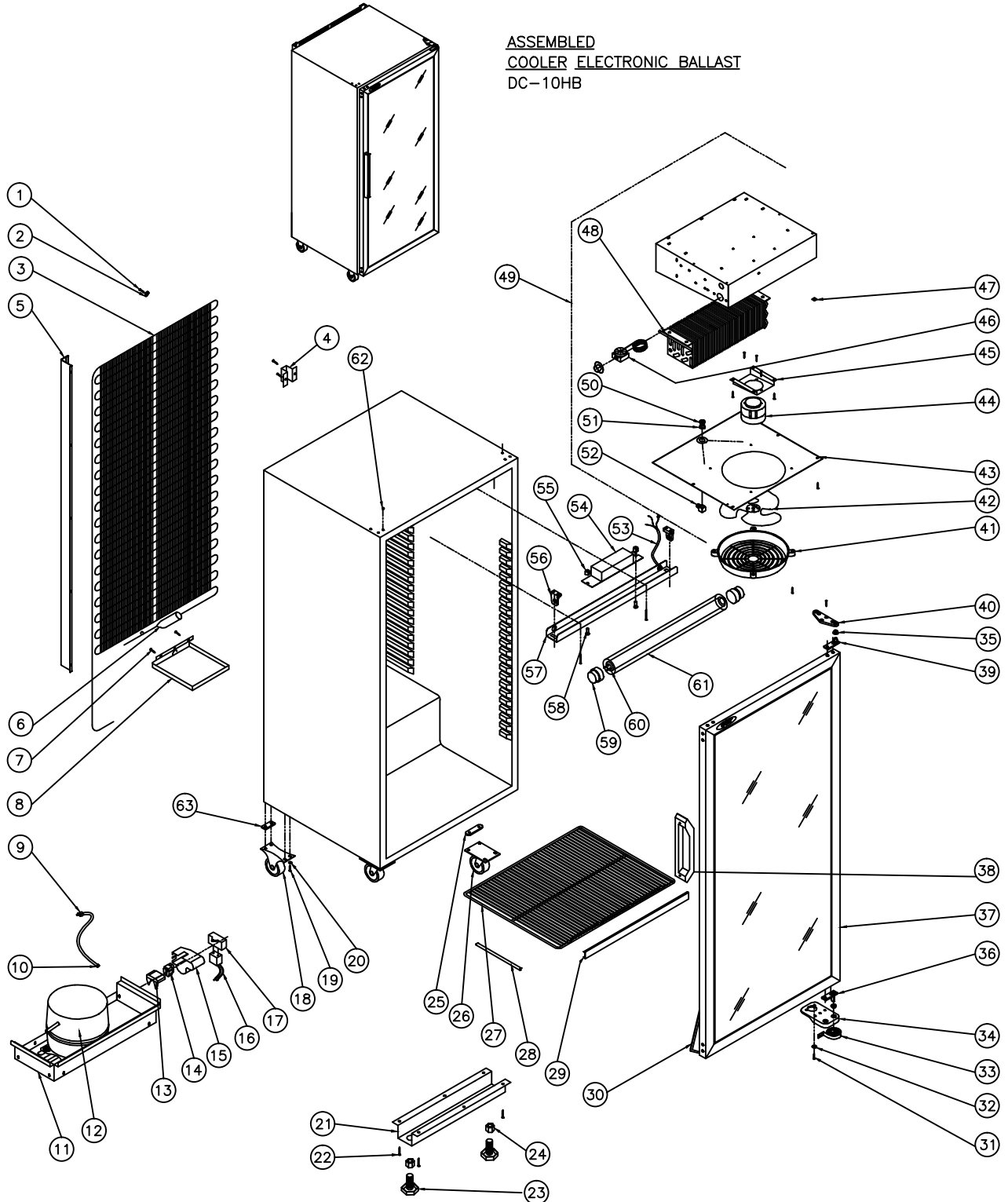



Cooling Systems Inc.

31 Bramstele Rd
Brampton, Ontario, Canada
L6W 3K6

Telephone: (905) 459-0709
Toll Free: (800) 633-3005
FAX: (905) 459-1478
info@qbd.com
www.qbd.com

DC10 Cooler

(34-9518-XXXL1) 120V, 60 Hz.

Item No.	Part No.	Pepsi Part No.	Description	Item No.	Part No.	Pepsi Part No.	Description
1	20-0468-012		SCW SM #8 x ¾ PH TR HD	34	47-0530-188	510498	Hinge, Bottom Bracket
2	47-0460-015		Washer, #8 - .187 ID ¾ OD	35	47-0080-006	510044	Insert, Bronze
3	47-0530-205		Condenser Coil DC12	36	47-0530-192	510386	Pin Pivot Bottom
4	47-0031-411		Standoff, Cond. Coil	37	47-7620-739	56788	Door Assy DC-10
5	47-7982-039		Channel, Back	38a	47-0010-615	59359	Handle Assy
6	47-0011-317		Drier Assy, ¼ Swagged	38b	47-0120-166	1002413	Handle, Recess Dr Charcoal Gray
7	53-0301-021		SCW SM #8 x ½ 'AB' PH TR HD	39	47-0530-190	510512	Pin Pivot Top
8	47-0031-413	69689	Tray, DC-7/DC-12HB Cond. Drip	40	47-0530-187	58186	Hinge, Top Bracket
9	18-7218-001	1007217	Cord Power 14/3 SJTW-A 12' LG	41	47-0120-095	69699	Guard Fan Evap-Black
10	09-1051-801	96815	Strain Relief Bushing	42	47-0530-531		Fan Blade
11	47-0031-450		Base, Refrigeration	43	47-0031-526	1005558	Tray, Shroud Drip
12	47-0530-191	1003060	Compressor TPA1370YXA Tecumseh	44a	47-0410-022	58269	Motor, Evaporator 5 Watt (older style)
13	47-0430-073	510442	Overload TPA1370YXA Tecumseh	44b	47-0410-024	83985	Motor, Evaporator 4 Watt
14	47-0430-074	510444	Relay TPA1370YXA Tecumseh	45	47-0031-527	81038	Bracket Motor Bent Mnt Evap
15	47-0430-076	510506	Cover, Elect.	46	47-0430-093	83987	Cold Control
16	47-0440-062		Capacitor, Wire Lead	47	18-7240-000		Nut 6-32 Speed J-Type
17	47-0430-075	510446	Capacitor TPA1370YXA Tecumseh	48	47-0530-206	68266	Evaporator Coil DC12
18	47-0530-209	69696	Wheel, 2½" Rigid DC10-12HB	49	47-0010-489		Shroud Assy. DC-10
19	47-0301-011		SCW SM 10 x 1½	50	31-4213-000	151668	Connector Drain ½ -20
20	53-0248-014		Washer Flat 10 218x500x0625 Zinc	51	47-0460-005	69695	Washer Drain Poly ½ ID x .687OD
21	47-0031-482		Support, DC12 Front Leg	52	31-4214-000	1003788	Drain Adapter
22	53-0301-021		SCW SM #8 x ½ 'AB' PH TR HD	53	47-0450-118	1006248	Harness, DC-7/10/12 Lamp(Strd)
23	47-0530-089	510204	Level Leg .500X3.000X1.375 AF	54	47-0530-263		Ballast, Electronic 1 Lamp
24	47-0264-513		Nut ½ -13 Hex Jam	55	20-0498-005		Nut 10-32 Keys
25	47-0530-212		Spacer, Wheel	56	47-0440-076	81809	Lamp Holder Eurotype Shunted
26	47-0530-208	67720	Wheel, 2½" Swivel	57	47-8058-033		Housing, DC10/12 Lamp.
27	47-0200-105	60089	Shelf, DC10-12HB Standard	58	47-0254-005		SCW MA 10 - 32 x .375 PH PAN HD
28	47-7993-033	81318	Clip, Shelf Stopper	59	47-0120-114	1020840	Cap,T8 Lamp Protector End
29	47-0130-250	1000819	Price Holder DC40/60 18¾" Black	60	47-0530-262	83983	Lamp Fluorescent Nom 18"
30	47-0140-009	82557	Gasket, DC-10HB Door Mag.	61	47-0120-117	58596	Protector Lamp Tubes(F15T8)
31	47-0400-024	510518	SCW ST- 8 - 32 x ½ PH FT HD BLK	62	47-0120-055	510516	Button, Belly Black
32	47-0460-015		Washer #8 .187 ID x ¾ OD x .031t	63	47-0530-216		Spacer, Back Wheel
33	53-0149-069	510108	Spring DC Hinged Door				

Accessories:

47-0034-128	61726	Key, Door T-Handle
47-0520-185	1000383	Door Lock, DC6/7/10/12
47-0520-198		Kit, Cold Control W/Knob 093
47-0520-204		Kit, Comp & Electrics TPA1370YXA
47-0520-207	1008771	Kit, Electrics for TPA1370YXA
47-0520-214	57175	Caster Kit – Uni-Directional
47-0520-216	1001844	Caster Kit – Swivel Type
47-0520-239	82964	Kit, DC10/12 LED Conversion
47-0520-245	1001883	Kit, Casters Transfer - No Wheels
47-7985-932	1000818	Decal, Door Pepsi DC10/12
47-7991-932		Decal, Side Pepsi DC10