

5. Exploded View & Part List

5-1 FPT5884X/XAA Exploded View

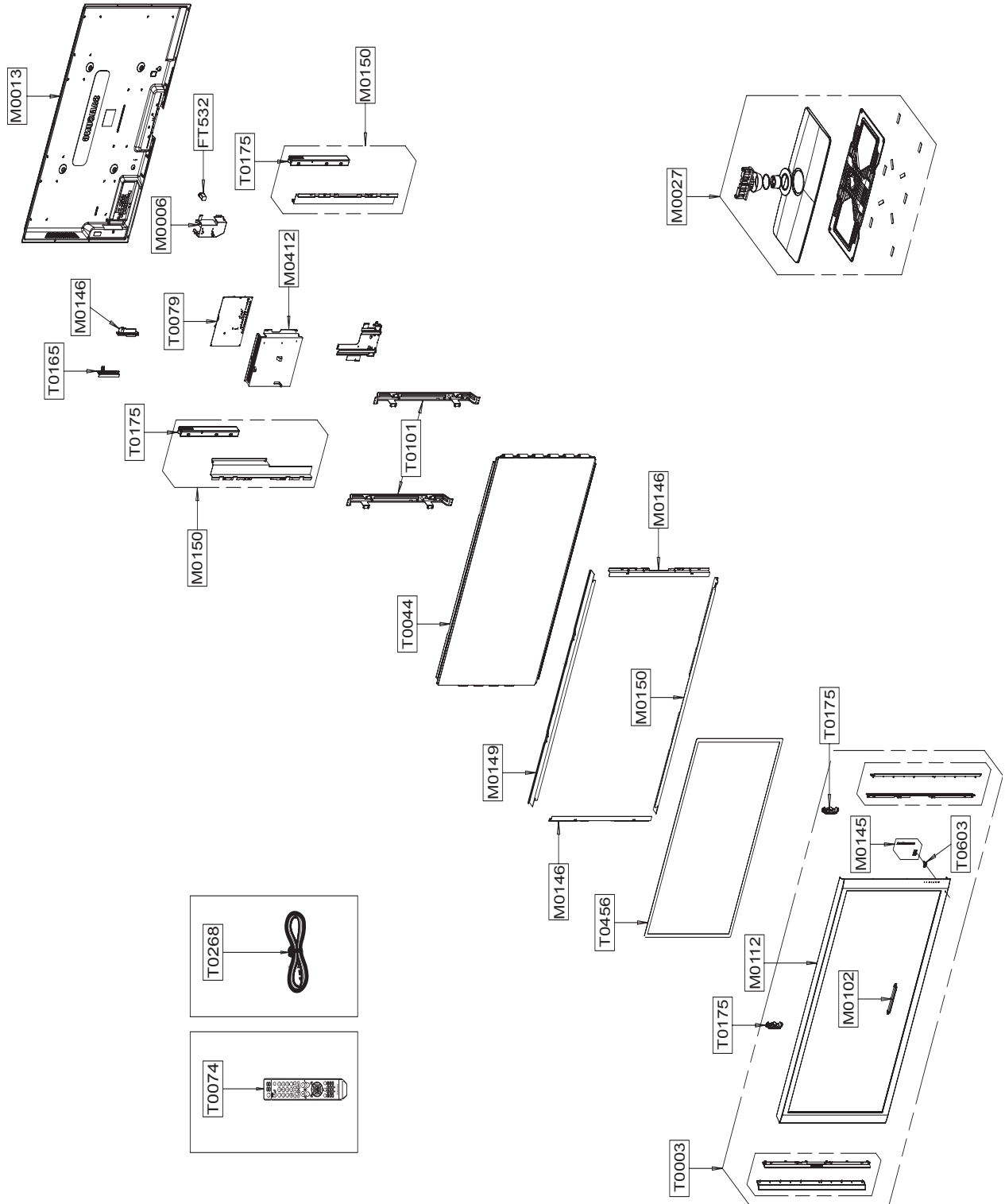

Loc. No.	Code No.	Description	Specification	Q'ty	SA/SNA	Remark
FT532	2901-001465	FILTER-EMI AC LINE	250V,8A,EK,UL,CSA,TUV	1	S.N.A	
M0006	BN96-06036A	ASSY SHIELD P-COVER	58P9,SECC 0.8	1	S.N.A	
M0013	BN96-05719A	ASSY COVER P-REAR	58P9,SECC T0.5	1	S.A	
M0027	BN96-05718A	ASSY STAND P-BASE	58P9,-,ABS+PMMA HB,BK2	1	S.A	
M0102	BN96-04802A	ASSY BLU P	Bordeaux Plus,BACK LIGHT UNIT	1	S.A	
M0112	BN63-03574A	COVER-FRONT	58P9,ABS+PMMA,-,-,HB,SEA,B	1	S.N.A	
M0145	BN96-05867A	ASSY BOARD P-TU FUNCTION IR	FPT5884X/XAA	1	S.A	
M0146	BN96-05714A	ASSY BRACKET P-FILTER RIGHT	58P9,AL A606	1	S.N.A	
M0146	BN96-05715A	ASSY BRACKET P-FILTER LEFT	58P9,AL A6063	1	S.N.A	
M0146	BN63-03577A	SHIELD CASE	58P9,SECC,0.5	1	S.N.A	
M0149	BN96-05712A	ASSY BRACKET P-FILTER TOP	58P9,AL A6063,	1	S.N.A	
M0150	BN96-05713A	ASSY BRACKET P-FILTER BOTTOM	58P9,AL A60	1	S.N.A	
M0150	BN96-05716A	ASSY BRACKET P-SUPPORT FILTER	58P9,AL A6	1	S.N.A	
M0150	BN96-05717A	ASSY BRACKET P-SUPPORT FILTER	58P9,AL A6	1	S.N.A	
M0412	BN96-05720A	ASSY BRACKET P-PCB	58P9,SECC T0.8	1	S.N.A	
T0003	BN96-05711A	ASSY COVER P-FRONT	58P9,-,ABS+PMMA HB,BK	1	S.A	
T0044	BN96-05638A	ASSY PDP MODULE P	PL58FH001A,S58FH-XB01,	1	S.A	△
T0074	BN59-00599A	REMOCON	Bordeaux plus,TM87C,SAMSUNG28P+E	1	S.A	
T0079	BN94-01187F	ASSY PCB MISC-MAIN	FPT5884X/XAA (P9),F35	1	S.A	△
T0101	BN61-03293A	BRACKET-WALL	58P9,SECC,2.0	2	S.N.A	
T0165	BN96-06008A	ASSY COVER P-AV	58P9,HIPS HB,BLK	1	S.N.A	
T0175	BN96-05589A	ASSY SPEAKER P	8ohm,P9 50" right, FR,sid	1	S.A	
T0175	BN96-05590A	ASSY SPEAKER P	8ohm,P9 50" Left, FR,side	1	S.A	
T0175	BN96-05587B	ASSY SPEAKER P	8ohm,P9 58" Right, woofer	1	S.A	
T0175	BN96-05588A	ASSY SPEAKER P	8ohm,P9 50" Left, woofer,	1	S.A	
T0268	3903-000144	CBF-POWER CORD	DT,US,BP3/Y,U(IEC C13-RA)	1	S.A	
T0456	BN67-00200A	GLASS-FILTER EMI	58" FHD with B/C,Mesh M	1	S.A	
T0603	BN64-00628A	WINDOW-RMC	50P9,PC,VIOLET	1	S.N.A	

5-2 FPT5884X/XAA Service Item

※ This is the list which is available to repair the real material at the time of service.

Loc. No.	Code No.	Description	Specification	Q'ty	Remark
M0013	BN96-05719A	ASSY COVER P-REAR	58P9,SECC T0.5	1	
M0027	BN96-05718A	ASSY STAND P-BASE	58P9,-,ABS+PMMA HB,BK2	1	
M2893	BN39-00802P	LEAD CONNECTOR	FPT5884X/XAA,UL1007#26,24	1	
M2893	BN39-00843C	LEAD CONNECTOR	FPT5084X/XAA,UL20276#30,4	1	
T0003	BN96-05711A	ASSY COVER P-FRONT	58P9,-,ABS+PMMA HB,BK	1	
T0044	BN96-05638A	ASSY PDP MODULE P	PL58FH001A,S58FH-XB01,	1	⚠
T1910	BN96-05640A	ASSY PDP MODULE P-X-MAIN BOARD	PL58FH001	1	
	BN96-05641A	ASSY PDP MODULE P-X-MAIN BUFFE	PL58FH001	1	
T1911	BN96-05642A	ASSY PDP MODULE P-Y-MAIN BOARD	PL58FH001	1	
T1960	BN96-05643A	ASSY PDP MODULE P-Y-MAIN UPPER	PL58FH001	1	
T1961	BN96-05644A	ASSY PDP MODULE P-Y-MAIN LOWWE	PL58FH001	1	
T1917	BN96-05645A	ASSY PDP MODULE P-LOGIC MAIN B	PL58FH001	1	
T1914	BN96-05646A	ASSY PDP MODULE P-ADDRESS E-BU	PL58FH001	1	
T1915	BN96-05647A	ASSY PDP MODULE P-ADDRESS F-BU	PL58FH001	1	
T1916	BN96-05648A	ASSY PDP MODULE P-ADDRESS G-BU	PL58FH001	1	
T0074	BN59-00599A	REMOCON	Bordeaux plus,TM87C,SAMSUNG28P+E	1	
T0079	BN94-01187F	ASSY PCB MISC-MAIN	FPT5884X/XAA (P9),F35	1	⚠
T0764	BN44-00183A	SMPS-PDP TV	Saffran 58,SEM,AC/DC,679.9W,	1	⚠