

PC.	STK. NO.	DESCRIPTION	QTY	PC.	STK. NO.	DESCRIPTION	QTY
1	105503	Spigot Plunger	1	41	107065	Brkt., Connector Mtg.	1
2	58923	O-Ring, Spigot Plunger	2		65637	3/8" Male Quick-Connect	1
3	65632-01	Handle, Spigot	1		65638	5/8" Male Quick-Connect	1
4	58911	O-Ring, Front Plate	1		65639	3/8" Female Quick-Connect	1
5	105610	Front Plate w/ Valve	1		65640	5/8" Female Quick-Connect	1
6	64065	Knob, Front Plate	2		65641	Mounting Flange	2
7	64255	Faspin	1		65642	Cap	2
8	105612	Vent Valve Assy	1 *		65643	Plug	2
	58952	O-Ring, Vent Plunger	1 *	42	102427	Gasket, Motor Mounting	1
	60335	Screw, Valve	1 *		104267	Saddle, Motor Support	1
	64420	Knob	1 *		104398-02	1/8" Spacer, Motor Support	2
	64508	Spring, Vent Plunger	1 *	43	65682	Solenoid Valve, Product	1
9	106865	Front Panel	1	44	71079	Solenoid Valve, Refrig.	1
10	106866	Upper Front Panel	1		71078	Solenoid Coil, Refrig.	1
	106867	Bottom, Upper Front	1	45	105615-01	Base, WB700	1
11	106875	Wiring Box Cover	1	46	64135	Leg	4
12	9584	Switch Decal	1	47	70037	Field Wiring Box	1
	70276	Lighted Rocker Switch	3		61041	Cover, Handy Box	1
13	7107	Front Plate Stud	2	48	75272	Dasher Motor	1
14	61395	Mix-Out Light	1		104194	Ground Wire	1
15	15671	Wiring Box Assy	1	49	108557	Mounting Brkt., Solenoid	1
	106873	Lid, Wiring Box	1	50	106869	Side Panel	2
16	3113-01	Dasher	1	51	108441	Drip Tray Support	1
17	65633	Stator Rod	1		106230	Drip Tray Insert	1
18	104984	Scrapor Blade	2	52	105623	Drip Tray Grid	1
19	106870	Top Cover Panel	1		108439	LEFT DRIP TRAY SUPT. BRKT.	1
20	100514	DRIP PAN W/SWITCH BARRIER	1		108440	RIGHT DRIP TRAY SUPT. BRKT.	1
21	108207	Pan Support Bracket	1		106204-5	Check/Test/Start Form	1
22	105600	Evaporator Assy	1		105504	Operator's Manual	1
	108517	Drain Tube Assy	1		188376	Spare Parts Kit	1
	104950	Drip Pan Inlet Tube	1		58375	PVC TUBING	2.5'
			1				4
23	106871	BOTTOM, WIRE BOX COVER	1				1
24	58917	O-Ring, Dasher	1				1
25	108541	Rear Seal Assy	1		71151	Expansion Valve	1
26	108208	Mix Pan Cover	1		71045	1/4" Access Valve	1
27	108210	Mix Pan Assy	1				1
	107364	Autofill Probe Assy	2		9509	"Torque Adj." Decal	1
	107365	Inner Insulator	2		9512	"Do Not Adj." Decal	1
	107366	Outer Insulator	2		9521	Patent Plate	1
28	106868	Back Panel	1		9580	Spigot Handle Tag	1
30	58885	Belt	1		9581	Arrow Sticker	1
31	58947	O-Ring, Mix Pan	2		9590	"Danger-Elec. Shock" Decal	2
32	104648	Cushion, Torque Idler	1		9593	Hazardous Moving Parts	2
33	104973	Torque Idler	1		9595	Front Plate Warning Label	1
	70008	Torque Switch	1		9921	Max. Inlet Pressure Label	1
	70068	Cover, Torque Switch	1		58377	PVC NYLO BRADE TUBE	.5
34	10208	Drive Pulley	1				1
	3632	Key, 3/16" Sqr.	1 *				1
35	10615	Driven Pulley	1				1
	3621	Key, 1/4" Sqr.	1				1
	107067	Guard, Pulley	1				1
36	2858	Bearing & Shaft Assy	1				1
37	103249	Belt Idler	1				1
38	105597	Evaporator Support	1				1
	105598	Torque Adj. Assy	1				1
	105613	Pulley, Torque Adj.	1				1
	64255	Faspin	1				1
39	64515	Spring, Torque	1				1
	105609	Torque Cable Assy	1				1
40	64515	Spring, Idler	1				1
	2959	Nut, Tension Adj.	1				1

107935 Rubber Pad

Saniserv.Net

NOTE: * FOR REPLACEMENT PART PURPOSES
81184 WIRING DIA.

UNLESS OTHERWISE SPECIFIED TOLERANCES				2020 PRODUCTION DRIVE INDIANAPOLIS, INDIANA 46241	
DECIMAL		FRACTIONAL		7000-RF-50	
.XX	± .015	1/64	± .004	Part: EXPLODED VIEW (7000-STNLS)	
.XX	± .010	ANGULAR	± 1°	Mod. No. 418700, STNLS B/U to	
.XX	± .005	± 1°		Drawn: RJS Chkd. Date 23JUN92	
REMOVE ALL BURRS AND BREAK SHARP EDGES				Scale: ~ 1 SHEET OF 2 B 180801 Rev. M	
DO NOT SCALE DRAWING					

Rev.	Revisions	Date	By
M	NUMEROUS CORRECTIONS	Edw 1270 3/19/02	JF
K	ITEM 16 WAS 3113-01 DASHER	7-19-91	0162

242
A 1808

Rev. K

Saniserv.Net

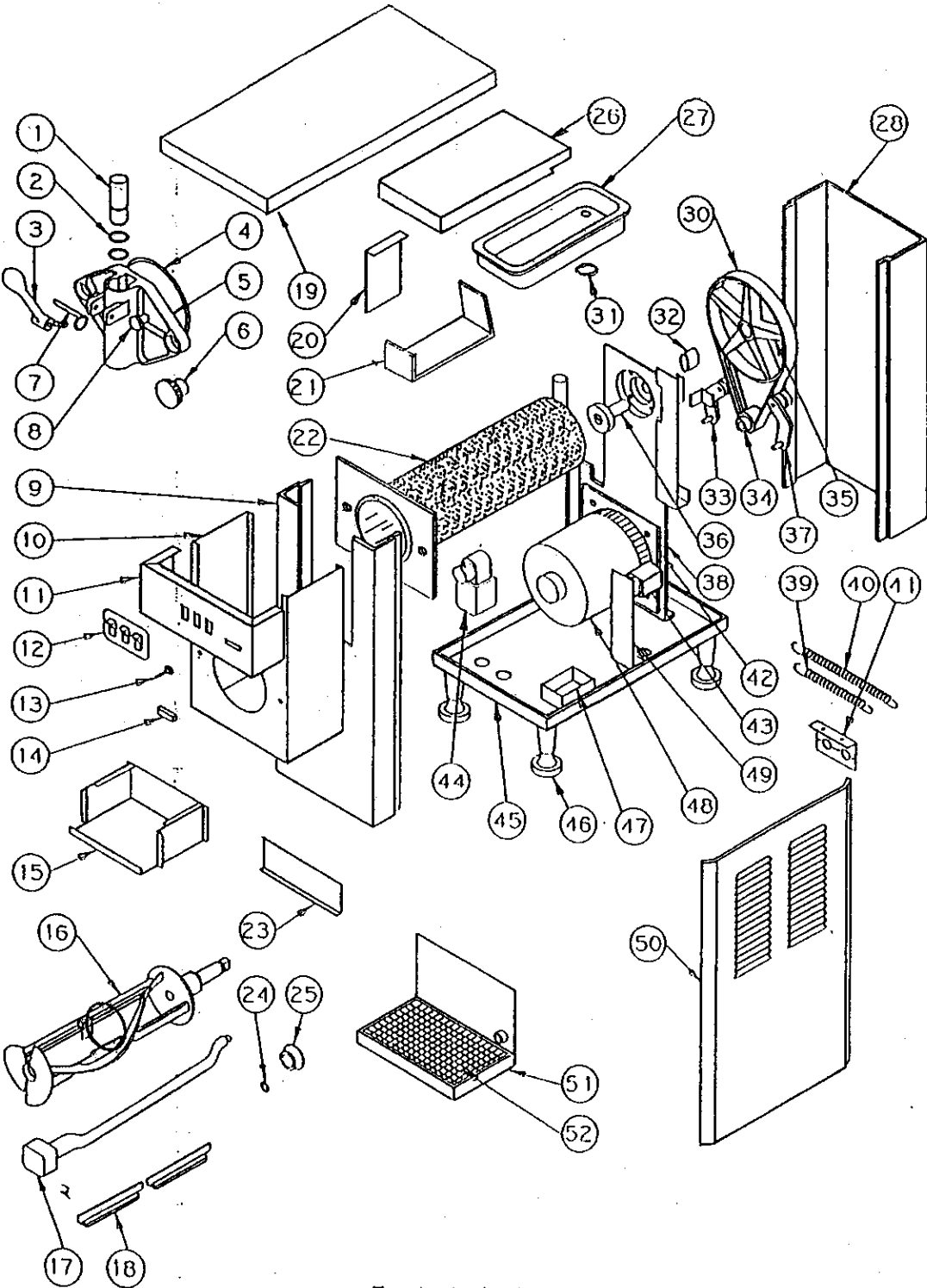

Exploded View

Material: - REFERENCE -

Mat. Stk. No.

Weight

A

2020 PRODUCTION DRIVE
INDIANAPOLIS, INDIANA 46241



Part: EXPLODED VIEW

Mod. No. WB700 - STNLS B/U to

Drawn: RJS Chkd.

Scale: ~ 2 SHEET OF 2 A 180801

Date 23JUN92

Rev. K

UNLESS OTHERWISE SPECIFIED TOLERANCES

DECIMAL	FRACTIONAL
.X ± .015	1/64 ± 1/64
.XX ± .010	ANGULAR ± 1°
.XXX ± .005	

REMOVE ALL BURRS AND BREAK SHARP EDGES
DO NOT SCALE DRAWING

Rev.	Revisions	Date	By