

Q2-500KL ONLY
 49 50



MODEL: QCS/RCS CONVEYOR TOASTER

THIS DRAWING CONTAINS INFORMATION CONFIDENTIAL TO STAR MFG. INT'L. INC.
 NO REPRODUCTION OR DISCLOSURE OF ITS CONTENTS IS PERMITTED.

PARTS LIST

November 23, 2010, Rev. J

QCS-3-1300, RCS-3-1300 Conveyor Toasters

Key Number	Part Number	Number Per Unit	Description
1	HH-101371	1	ENCLOSURE QCS/RCS-3
2	HH-402470	1	PANEL, BACK QCS/RCS-3
3	2E-200574	1	SWITCH, FAN CERAMIC
4	HG-402144	1	BRACKET, FAN SWITCH
5	2U-200561	1	MOTOR, FAN
6	2U-200509	1	MOTOR, DRIVE, FAN BLADE NOT INCLUDED
	2R-Z8879	1	FAN BLADE, MOTOR
7	2A-202902	1	SHAFT, DRIVE
8	HA-112261	2	BUSHING, REAR
9	2P-Z8779	1	SPROCKET, DRIVEN (25B11 X 5/16")
10	2P-200645	1	SPROCKET, DRIVE (25B17 X 5/16")
11	2P-150013	1	CHAIN, DRIVE (19")
12	2P-115501	3	JUMPER, TERMINAL BLOCK, SMALL, 2 POS.
13	2P-115502	1	JUMPER, TERMINAL BLOCK, SMALL, 3 POS.
14	HC-115381	2	BLOCK, TERMINAL, SMALL, 4 POS.
15	H9-Z10282	1	BLOCK, TERMINAL, SMALL, 10 POS.
16	2R-200562	1	GUARD, FAN MOTOR
17	2R-200709	4	LEG, 1" CHROME PLASTIC
18	2P-200736	2	SPRING, BUSHING, FRONT
19	2P-200700	2	BUSHING, FRONT
20	2A-202905	1	SHAFT, IDLER
21	SP-160028	1	CONVEYOR, BELT (14" X 35")
22	2B-200603	3	LINK, MASTER, CONVEYOR BELT
23	HH-100561	1	TRAY, PULL-OUT
24	HH-402465	1	TRAY, CRUMB
25	2R-200788	1	GUARD, CRUMB TRAY
26	2B-200764	1	WIRE RACK, LOAD-UP
28	2A-200284	1	E-CIIP
29	HI-100573	1	BAFFLE, AIR FLOW LOW
30	2E-200551	1	SWITCH, ROTARY POWER SAVER
31	2J-200538	2	SWITCH, INFINITE
32	2P-402728	1	ANTI-SPIN PLATE
33	SP-118042	1	SWITCH, SPEED CONTROL, (500W)
34	2E-200566	1	SWITCH, HIGH LIMIT RESET
35	2R-200708	4	CAP, KNOB
36	2R-200768	3	KNOB, SPEED CONTROL, INFINITE SWITCH
	2R-200768	1	KNOB, POWER SAVER (manufactured before 11/2001)
	2R-200769	1	KNOB, POWER SAVER (manufactured after 11/2001)
37	2M-200864	1	LABEL, CONTROL PANEL QCS
	2M-200899	1	LABEL, CONTROL PANEL, RCS
38	HC-402499	1	RETAINER, ELEMENT, 6 TUBE
	HE-402544	1	RETAINER, ELEMENT RCS
39	HJ-198060	6	HEATER TUBE QUARTS, 208V (8.4 Ω , 540W, 7.79A) (UNIT = 15.4 A)
	HH-198053	6	HEATER TUBE QUARTS, 220V (9.7 Ω , 525W, 7.13A) (UNIT = 14.9 A)
	HJ-198054	6	HEATER TUBE QUARTS, 240V (11.24 Ω , 535W, 6.71A) (UNIT = 13.3 A)
40	SEE TABLE		ELEMENT, METAL RCS
41	SEE TABLE		ELEMENT, SERPENTINE RCS
42	HI-101116	1	TRAY, CRUMB ASSEMBLY, QCS/RCS - 3
43	2A-Z9394	2	SPRING BEARING HOUSING
44	2C-1487	2	SCREW 6-32X1/4 RHP ST, FUSEHOLDER
45	2C-H8669	2	WASHER #6 INT STL NP
46	2C-2553	2	NUT 6-32 HEX STL NP
47	2E-Z5681	1	FUSEHOLDER, CLASS G
48	2E-Z5680	2	FUSE, 5A - CLASS G
NI	2B-200610	1	LINK, CONVEYOR BELT
NI	HJ-140027	1	CORD, POWER (NEMA 6-30)
NI	2E-200387	1	CORD, FAN MOTOR
NI	2R-200721	1	BLADE, FAN 2-5/16"
NI	2K-200465	1	BUSHING, CORD HEYCO
NI	1L-Z12397	1	EXTREME PRESSURE MULTIPURPOSE SYNTHETIC GREASE (80°F TO 400°F) 1 oz. TUBE



PARTS LIST

RCS Conveyor Toasters HEATER TUBES

Key Number	Description	Part Number	Number Per Unit
40	R2-50, 120V	2N-209100	4
	RCS-2-600H, 240V	2N-209106	4
	RCS-2-600H, 208V	2N-209197	4
	RCS-2-600HJ, 208V	2N-209199	4
	RCS-2-600HJ, 240V	2N-209216	4
	RCS-2-800, 240V	2N-209106	4
	RCS-2-800, 208V	2N-209197	4
	RCS-2-1200B, 208V	2N-209198	2
	RCS-3-950H, 208V	2N-209130	4
	RCS-3-950H, 240V	2N-209160	4
	RCS-3-1000, 208V	2N-209130	4
	RCS-3-1000, 240V	N/A	N/A
	RCS-3-1300, 208V	2N-209150	4
	RCS-3-1300, 208V	2N-209131	6
	RCS-3-1300, 240V	2N-209180	4
	RCS-3-1300, 240V	N/A	N/A
41	9H-R2-12BSH-V02	2N-209108	2
	9H-R2-12BA-V04	2N-209112	2
	9H-R2-12BASH-V04	2N-209112	2
	9H-R2-12BA-V02	2N-209114	2
	9H-R2-12BASH-V02	2N-209114	2

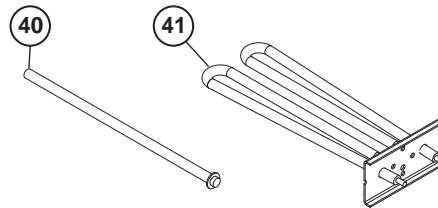

RCS HEATER TUBES