



**T&S BRASS AND BRONZE WORKS, INC.**  
 2 Saddleback Cove / P.O. Box 1088  
 Travelers Rest, SC 29690

Model No.  
**B-23K-NS**

Item No.

Travelers Rest, SC: 800-476-4103 • Simi Valley, CA: 800-423-0150 • Fax: 864-834-3518 • www.tsbrass.com

This Space for Architect/Engineer Approval

Job Name \_\_\_\_\_ Date \_\_\_\_\_

Model Specified \_\_\_\_\_ Quantity \_\_\_\_\_

Customer/Wholesaler \_\_\_\_\_

Contractor \_\_\_\_\_

Architect/Engineer \_\_\_\_\_

000607-40NS  
Bonnet Assembly



001466-20  
Quarter-Turn  
Spindle Sleeve



001908-25  
Eterna Spindle  
Insert (LH)



001479-45  
Check Spring



003164-45  
Seat Washer

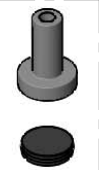

000789-20  
Removable Insert  
Assembly (LH)



LTC Cold Cartridge



000607-40NS  
Bonnet Assembly



001466-20  
Quarter-Turn  
Spindle Sleeve



001907-25  
Eterna Spindle  
Insert (RH)



001479-45  
Check Spring



003164-45  
Seat Washer



000788-20  
Removable Insert  
Assembly (RH)



RTC Hot Cartridge

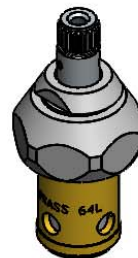

Product Specifications:  
 Quarter-Turn Eterna Cartridges w/ Spring Checks Parts Kit

Product Compliance:  
 ASME A112.18.1 / CSA B125.1  
 NSF 61 - Section 9  
 NSF 372 (Low Lead Content)