



# T&S BRASS AND BRONZE WORKS, INC.

2 Saddleback Cove / P.O. Box 1088  
Travelers Rest, SC 29690

Model No.

**EC-3102-SMT4V05**

Item No.

Travelers Rest, SC: 800-476-4103 • Simi Valley, CA: 800-423-0150 • Fax: 864-834-3518 • www.tsbrass.com



**ADA Compliant**

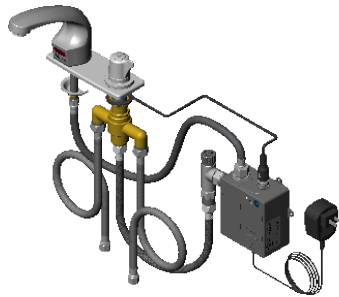

This Space for Architect/Engineer Approval

Job Name \_\_\_\_\_ Date \_\_\_\_\_

Model Specified \_\_\_\_\_ Quantity \_\_\_\_\_

Customer/Wholesaler \_\_\_\_\_

Contractor \_\_\_\_\_

Architect/Engineer \_\_\_\_\_

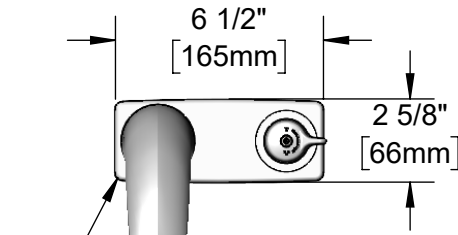

Chrome Plated Die Cast Deck Plate

Solid Cast Brass Spout w/ Polish Chrome Plated Finish and 2.2 GPM [8.3 L/min] Vandal Resistant Aerator

EC-SMT Above Deck Side Mount Adjustable Thermostatic Mixing Valve w/ Check Valves

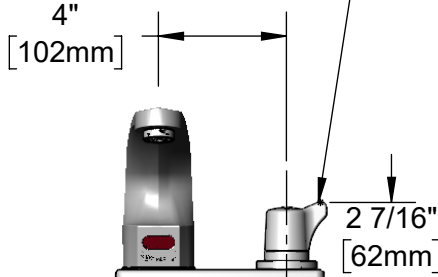
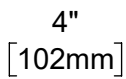

1/2" NPSM x 1/4" NPSM 18" [457mm] Flexible Stainless Steel Hose

Removable Strainer

24" [610mm] Sensor Cable

4" x 4 3/8" x 2 3/16" Deep [102mm x 111mm x 56mm] Water Resistant Control Module Box (Grey) w/ Internal Flow Control Setting Switches, AC or DC Operated w/ (4) AA Batteries. Hardwire Capable Using Terminals on Back

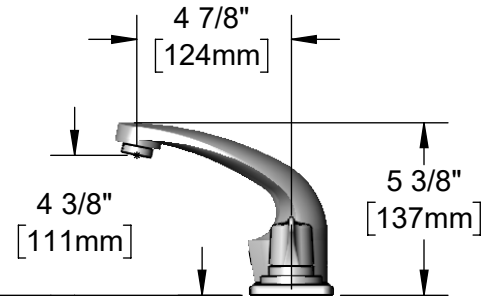

Mounting Surface

7/8" [22mm] Maximum Thickness

100-240 VAC Adapter w/ 72" [1830mm] Power Cord

VR Aerator Key (Included)

VR Screw L-Key (Included)

Shank Nut Wrench (Included)

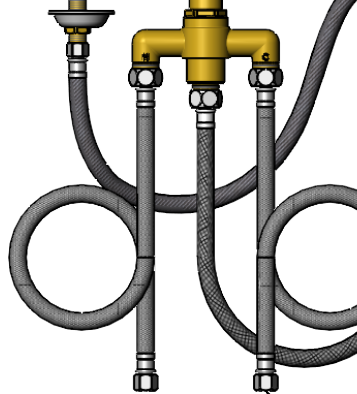

1/2" NPSM x 1/2" NPSM 16" [406mm] Flexible Stainless Steel Hose

Rough-In Requirement:  
(2)  $\phi$  1" [25mm] Mounting Holes

(2) 3/8" Compression x 1/2" NPSM 18" [457mm] Flexible Stainless Steel Supply Hoses

**Product Specifications:**

Chrome Plated Brass Electronic Faucet: Single Hole Deck Mount Spout w/ 0.5 GPM VR Non-Aerated Spray Device, 4" Centers Deck Plate, Above Deck Side Mount Adjustable Thermostatic Mixing Valve w/ Check Valves, AC/DC Control Module with Internal Flow Control Setting Switches, 18" Hot & Cold Supply Stop Flexible Connector Hoses

**Product Compliance:**

ASME A112.18.1 / CSA B125.1  
NSF 61 - Section 9  
NSF 372 (Low Lead Content)  
ANSI A117.1 (ADA)  
UL 1951  
ASSE 1070 (TMV)



# T&S BRASS AND BRONZE WORKS, INC.

2 Saddleback Cove / P.O. Box 1088  
Travelers Rest, SC 29690

Model No.

**EC-3102-SMT4V05**

Item No.

Travelers Rest, SC: 800-476-4103 • Simi Valley, CA: 800-423-0150 • Fax: 864-834-3518 • www.tsbrass.com

ITEM NO.	SALES NO.	DESCRIPTION
1	<a href="#">B-0199-08-N05</a>	0.5 GPM VR Spray Device, 13/16-27 Male
2	<a href="#">015425-45</a>	Vandal Resistant Key
*3	<a href="#">019174-45</a>	Sensor Cable Assembly
4	<a href="#">016297-45</a>	Inlet Hose, Faucet, 1/2" NPSM-F x 1/4" NPSM-F
5	<a href="#">EC-SMT</a>	Above Deck Thermostatic Mixing Valve w/ Handle
6	<a href="#">EC-FILTER</a>	Replacement Filter
*7	<a href="#">019944-45</a>	ChekPoint Control Module w/ Filter Tee
*8	<a href="#">5EF-0002C</a>	AC Adapter - US Plug
9	<a href="#">002534-25</a>	Close Nipple, 1/2" NPT
10	<a href="#">016167-45</a>	Supply Hose, 1/2" NPSM Female Ends
11	<a href="#">5EF-0005</a>	Supply Hose, 9/16-24 Female x 1/2" NPSM

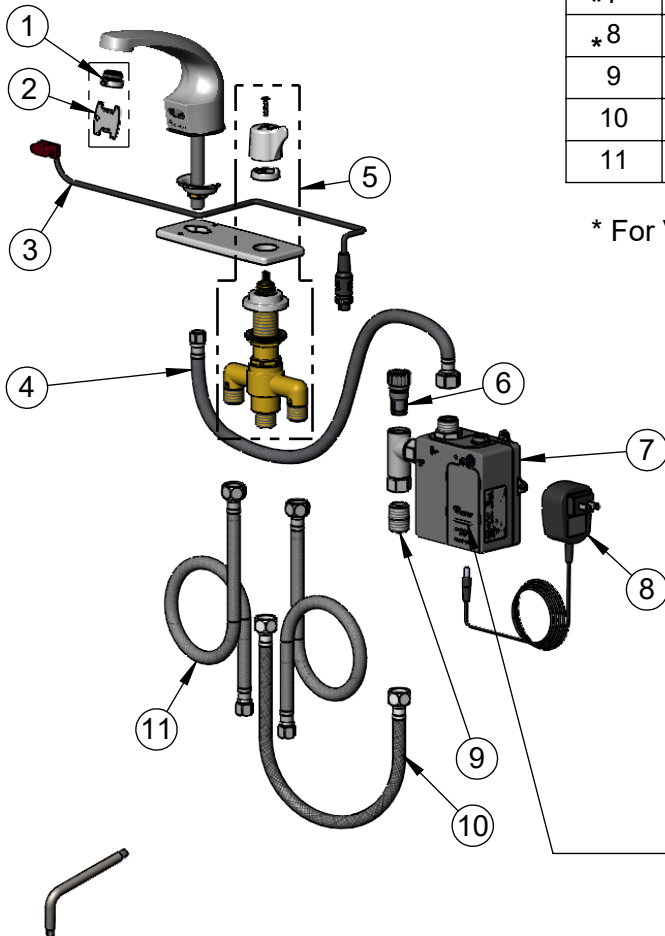

\* For Versions Prior to 2021, Consult with T&S Customer Service

A Maximum of (8) ChekPoint Faucets can be Hardwire Connected and Powered by [EC-HARDWIRE](#) ChekPoint Hardwire AC Transformer. (Sold Separately)

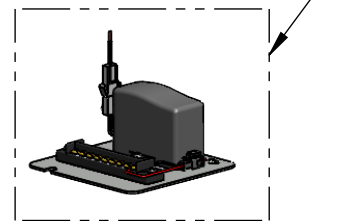

Flow Control Switches are Located Behind Battery Compartment Cover.

- \* Switches are Set to DEFAULT Position:
- Auto Time Out = 15 Seconds
  - Shut Off Delay = 1 Second
  - Auto Flush = OFF
  - Metering Mode = OFF

[018543-45](#)  
VR Screw L-Key

**\* Available Water Flow Control Selections:**

- Auto Time Out: 15 sec, 30 sec, 45 sec, 60 sec, 3 min, 20 min
- Shut Off Delay: 1 sec, 10 sec, 15 sec, 30 sec
- Auto Flush (30 Seconds After Every 12 Inactive Hours): ON or OFF
- Metering Mode: ON or OFF

**Product Specifications:**

Chrome Plated Brass Electronic Faucet: Single Hole Deck Mount Spout w/ 0.5 GPM VR Non-Aerated Spray Device, 4" Centers Deck Plate, Above Deck Side Mount Adjustable Thermostatic Mixing Valve w/ Check Valves, AC/DC Control Module with Internal Flow Control Setting Switches, 18" Hot & Cold Supply Stop Flexible Connector Hoses

**Product Compliance:**

ASME A112.18.1 / CSA B125.1  
NSF 61 - Section 9  
NSF 372 (Low Lead Content)  
ANSI A117.1 (ADA)  
UL 1951  
ASSE 1070 (TMV)